



PARTS CATALOGUE

YZ450F (BR96) EUROPE



1UBR9-300E1



<http://www.pdf-tools.com>

YZ450F

PARTS CATALOGUE

©2018 by Yamaha Motor Co., Ltd.

1st edition, June 2018

All rights reserved.

Any reprinting or unauthorized use
without the written permission of

Yamaha Motor Co., Ltd.

is expressly prohibited.

Printed in Japan.

FOREWORD

This Parts Catalogue is related to the parts for the model(s) on the cover page. When you are ordering replacement parts, please refer to this Parts Catalogue and quote both part numbers and part names correctly.

1. Modifications or additions which have been made after the issue of the Parts Catalogue will be announced in the Parts News.
It is advisable that you make the necessary corrections to the Parts Catalogue according to the Parts News.

2. Abbreviations

The following abbreviations are used in this Parts Catalogue.

“UR” Use specified parts number.

“UN” Use as many as needed.

“AP” Alternate Parts

“LM” Locally Made (Parts need to be ordered locally)

“F#” Frame No. (Applicable machine No.)

“O/S” Over Size

3. The number of components for assembly

- Parts, which are to be supplied in an assembly, are listed with a dot (.) in front of the part name as shown below.
- The numeral appearing to the right of each component part indicates the quantity of parts for each assembly unit.

PART NO.	DESCRIPTION	Q'TY	REMARKS
2F5-83310-60	FRONT FLASHER LIGHT ASSY	2	
115-83311-60	.BULB (6V-18W)	1	

4. Applicable colours of graphics are represented in the “REMARKS” as shown below.

PART NO.	DESCRIPTION	Q'TY	REMARKS
2N4-24110-00-X5	FUEL TANK COMP.	2	MXR
3J1-24240-10	.GRAPHIC, FUEL TANK	1	FOR MXR

5. Note that the illustrations for reference in finding parts numbers are not to be used for assembling. When assembling, please use the applicable service manual.

6. The asterisk (*) before a reference number indicates modified items after the first edition.

FOREWORD

7. Applicable Serial No.

Engine Serial No.

Frame Serial No.

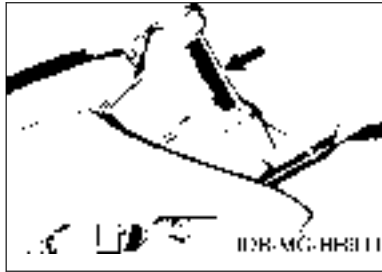
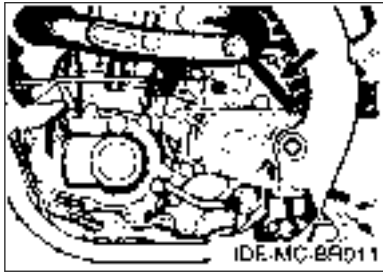

8. Applicable Colour Code (The (*) mark shows Model colour.)

Abbreviation	Colour Name	Colour Code
DPBSE(*)	DEEP PURPLISH BLUE SOLID E	0583

<http://www.pdf-tools.com>

CONTENTS

ENGINE

CYLINDER.....	1
CRANKSHAFT & PISTON.....	3
VALVE.....	4
CAMSHAFT & CHAIN.....	6
WATER PUMP.....	7
RADIATOR & HOSE.....	8
OIL PUMP.....	9
OIL CLEANER.....	10
INTAKE.....	11
INTAKE 2.....	13
AIR INDUCTION SYSTEM.....	14
EXHAUST.....	15
CRANKCASE.....	17
CRANKCASE COVER 1.....	19
STARTER CLUTCH.....	20
CLUTCH.....	21
TRANSMISSION.....	22
SHIFT CAM & FORK.....	24
SHIFT SHAFT.....	25

CHASSIS

FRAME.....	26
FENDER.....	28
SIDE COVER.....	29
REAR ARM.....	31
REAR SUSPENSION.....	33
STEERING.....	34
FRONT FORK.....	35
FUEL TANK.....	37
SEAT.....	38
FRONT WHEEL.....	39
FRONT BRAKE CALIPER.....	40
REAR WHEEL.....	41
REAR BRAKE CALIPER.....	43
STEERING HANDLE & CABLE.....	44
FRONT MASTER CYLINDER.....	45
STAND & FOOTREST.....	46
REAR MASTER CYLINDER.....	47
GENERATOR.....	48

STARTING MOTOR.....	49
HANDLE SWITCH & LEVER.....	50
ELECTRICAL 1.....	51
ELECTRICAL 2.....	52
ALTERNATE FOR CHASSIS.....	54

INDEX

NUMERICAL INDEX.....	55
----------------------	----

FIG. 1 CYLINDER

REF. NO.	PART NO.	DESCRIPTION	BR96	REMARKS
1	BR9-11102-00	CYLINDER HEAD ASSY	1	
2	5PS-11133-10	.GUIDE, VALVE 1	2	
3	5PS-11134-10	.GUIDE, VALVE 2	2	
4	90105-06027	.BOLT, FLANGE	8	
5	90340-12007	.PLUG, STRAIGHT SCREW	1	
6	91808-16023	.PIN, DOWEL	2	
7	91808-16023	.PIN, DOWEL	2	
8	95022-08012	BOLT, FLANGE	1	
9	90430-08119	GASKET	1	
10	95022-06010	BOLT, FLANGE	2	
11	90430-06014	GASKET	2	
12	90116-06037	BOLT, STUD	3	
13	94701-00415	PLUG, SPARK (NGK CPR8EA-9)	1	STD
	94701-00431	PLUG, SPARK (NGK R CPR9EA-9)	1	AP
14	BR9-11181-00	GASKET, CYLINDER HEAD 1	1	
15	93612-16254	PIN, DOWEL	2	
16	90105-10367	BOLT, FLANGE	3	
17	90105-10163	BOLT, FLANGE	1	
18	90201-10025	WASHER, PLATE	4	
19	95022-06035	BOLT, FLANGE	2	
20	BR9-81128-00	CLAMP	1	
21	BR9-11190-10	COVER, CYLINDER HEAD 1	1	
22	90116-06048	.BOLT, STUD	1	
23	341-11167-00	.PIPE, BREATHER 2	1	
24	5BE-12241-00	GUIDE, STOPPER 2	1	
25	33D-11193-01	GASKET, HEAD COVER 1	1	
26	5UM-1119E-00	BOLT, COVER HEAD	2	

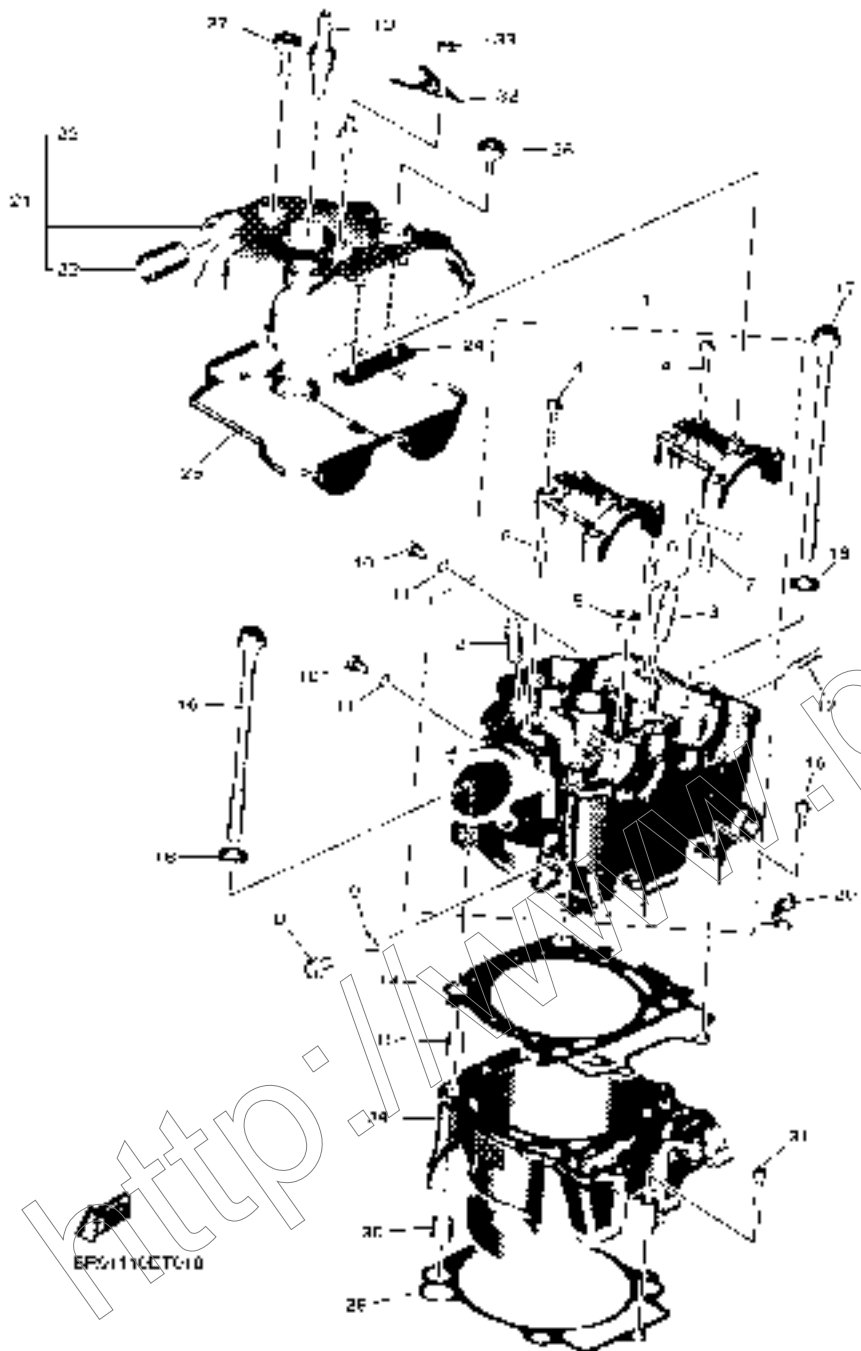

FIG. 2 CRANKSHAFT & PISTON

REF. NO.	PART NO.	DESCRIPTION	BR96				REMARKS
1	BR9-11400-00	CRANKSHAFT ASSY	1				
2	BR9-11412-00	.CRANK 1	1				
3	BR9-11422-00	.CRANK 2	1				
4	5TG-11681-01	.PIN, CRANK 1	1				
5	93310-63458	.BEARING	1				
6	33D-11651-03	.ROD, CONNECTING	1				
7	93306-30633	BEARING	2				
8	2S2-11536-00	GEAR, DRIVE	1				
9	BR9-11455-00	SHAFT 1	1				
10	93306-20335	BEARING	2				
11	2S2-11531-10	GEAR, BALANCE WEIGHT	1				
12	90170-14171	NUT	1				
13	90215-14287	WASHER, LOCK	1				
14	33D-11454-00	WEIGHT 1	1				
15	90149-06083	SCREW	3				
16	33D-11464-00	WEIGHT 2	1				
17	90282-05034	KEY, STRAIGHT	1				
18	90170-10013	NUT	1				
19	90215-10009	WASHER, LOCK	1				
20	BR9-116A0-00	PISTON ASSY	1				
21	BR9-11631-00	.PISTON (STD)	1				
22	33D-11603-00	.PISTON RING SET (STD)	1				
23	BR9-11633-00	.PIN, PISTON	1				
24	93450-19052	.CIRCLIP	2				
25	90280-03006	KEY, WOODRUFF	1				

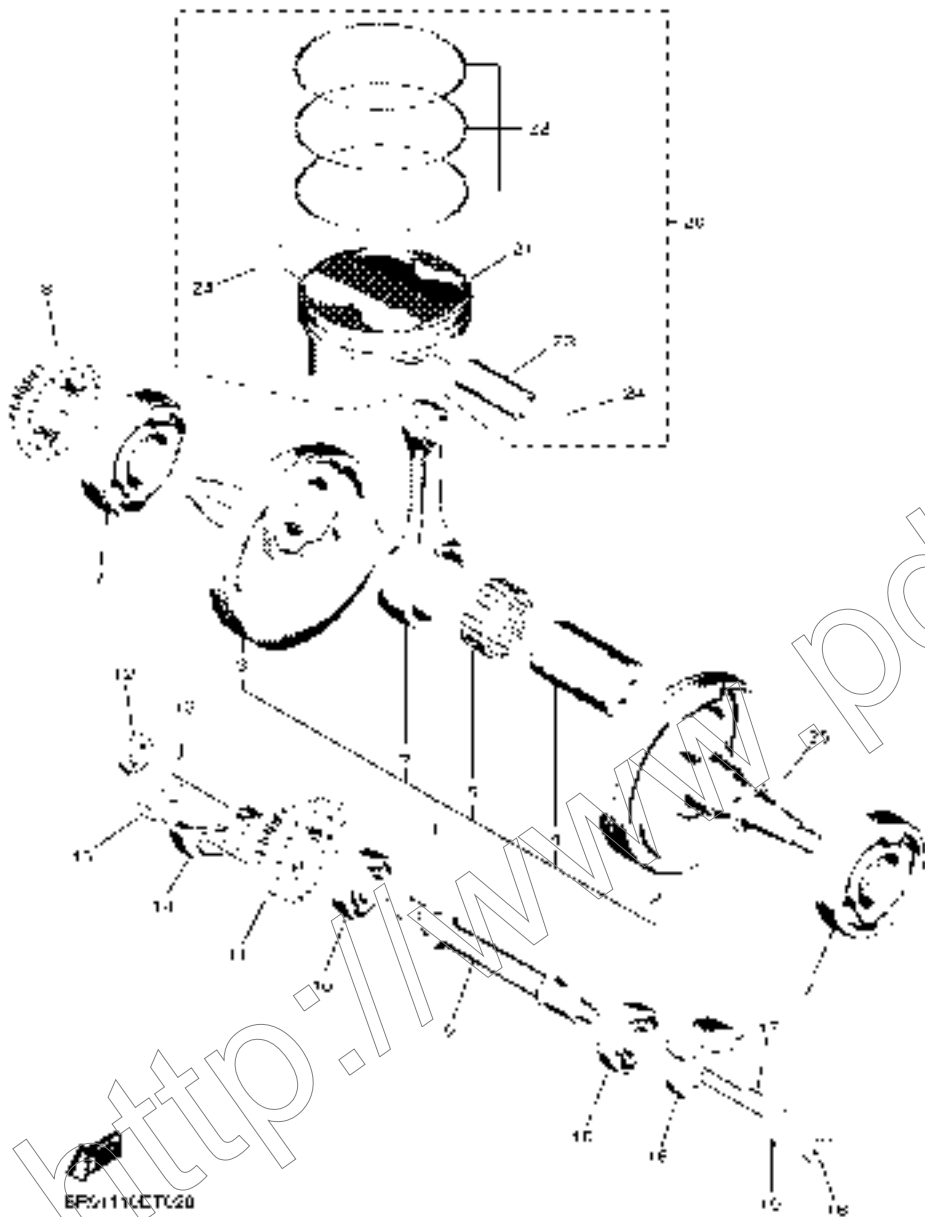

FIG. 3 VALVE

REF. NO.	PART NO.	DESCRIPTION	BR96	REMARKS
1	1SL-12111-00	VALVE, INTAKE	2	
2	1SL-12121-00	VALVE, EXHAUST	2	
3	51Y-12119-00	SEAL, VALVE STEM	4	
4	33D-12116-00	SEAT, VALVE SPRING	2	
5	33D-12126-00	SEAT, VALVE SPRING 2	2	
6	BR9-12113-00	SPRING, VALVE INNER	2	
7	BR9-12114-00	SPRING, VALVE OUTER	2	
8	33D-12117-00	RETAINER, VALVE SPRING	2	
9	3LD-12117-00	RETAINER, VALVE SPRING	2	
10	3LD-12118-00	LOCK, VALVE SPRING RETAINER	8	
11	BR9-12153-00	LIFTER, VALVE	2	STD
12	5EB-12153-10	LIFTER, VALVE	2	STD YELLOW
13	3LD-12168-00	PAD, ADJUSTING (1.20)	4	UR
	3LD-12168-20	PAD, ADJUSTING (1.25)	4	UR
	3LD-12168-40	PAD, ADJUSTING (1.30)	4	UR
	3LD-12168-60	PAD, ADJUSTING (1.35)	4	UR
	3LD-12168-80	PAD, ADJUSTING (1.40)	4	UR
	3LD-12168-A0	PAD, ADJUSTING (1.45)	4	UR
	3LD-12168-F0	PAD, ADJUSTING (1.50)	4	UR
	3LD-12168-H1	PAD, ADJUSTING (1.55)	4	UR
	3LD-12168-K1	PAD, ADJUSTING (1.60)	4	UR
	3LD-12168-M1	PAD, ADJUSTING (1.65)	4	UR
	3LD-12168-R1	PAD, ADJUSTING (1.70)	4	UR
	3LD-12168-U1	PAD, ADJUSTING (1.75)	4	UR
	3LD-12168-W1	PAD, ADJUSTING (1.80)	4	UR
	3LD-12168-Y1	PAD, ADJUSTING (1.85)	4	UR
	3LD-12169-11	PAD, ADJUSTING (1.90)	4	UR

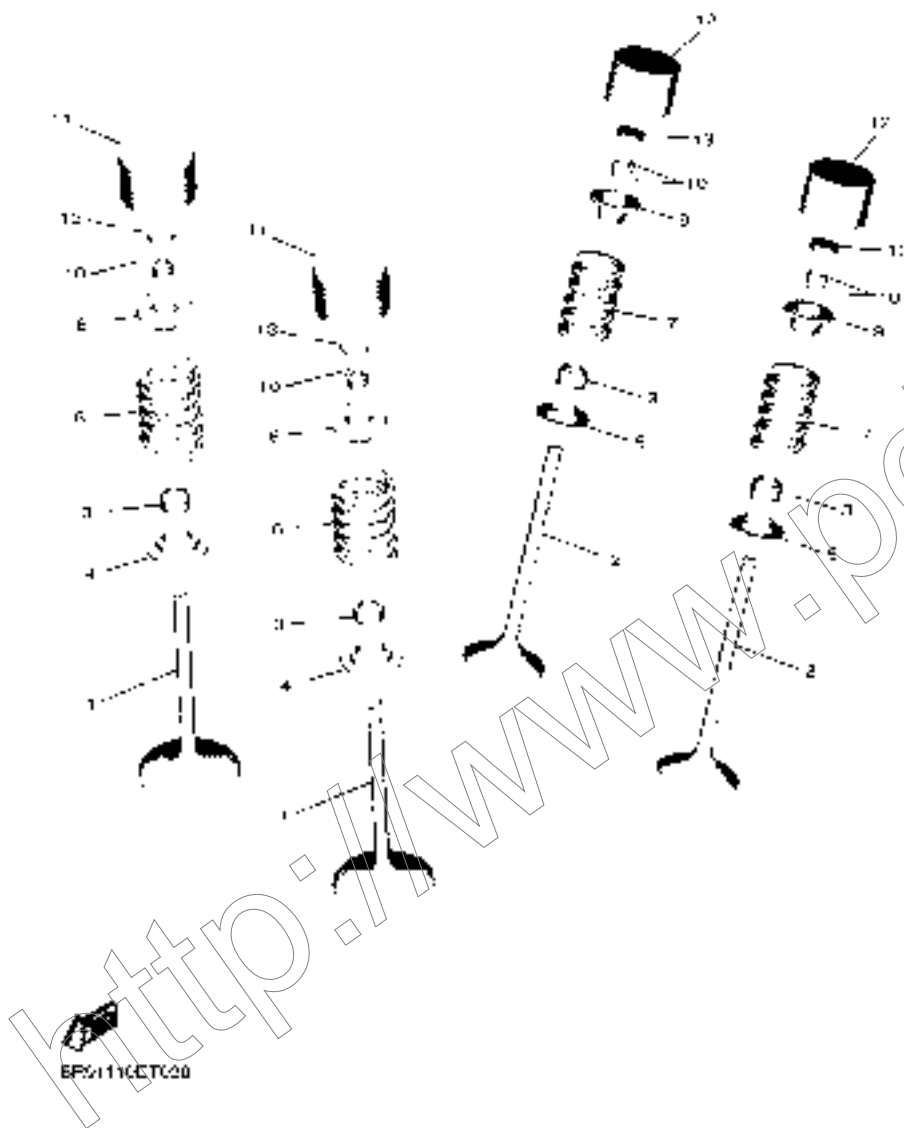
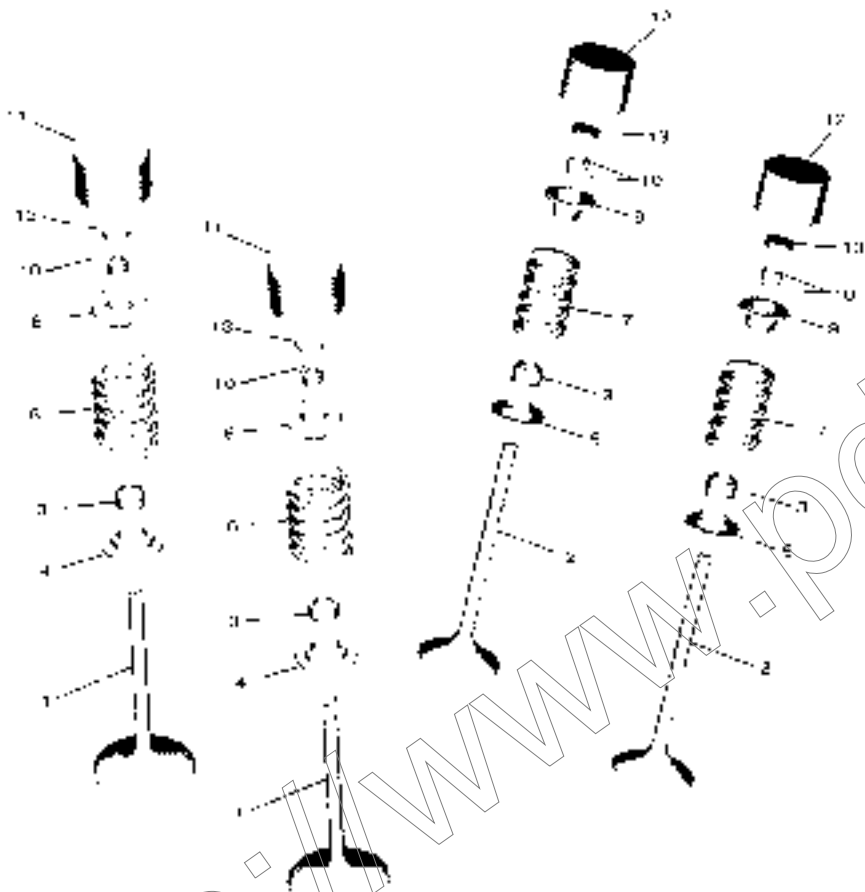

FIG. 3 VALVE

REF. NO.	PART NO.	DESCRIPTION	BR96	REMARKS
13	3LD-12169-31	PAD, ADJUSTING (1.95)	4	UR
	3LD-12169-50	PAD, ADJUSTING (2.00)	4	UR
	3LD-12169-70	PAD, ADJUSTING (2.05)	4	UR
	3LD-12169-90	PAD, ADJUSTING (2.10)	4	UR
	3LD-12169-E0	PAD, ADJUSTING (2.15)	4	UR
	3LD-12169-G0	PAD, ADJUSTING (2.20)	4	UR
	3LD-12169-J0	PAD, ADJUSTING (2.25)	4	UR
	3LD-12169-L0	PAD, ADJUSTING (2.30)	4	UR
	3LD-12169-N0	PAD, ADJUSTING (2.35)	4	UR
	3LD-12169-T0	PAD, ADJUSTING (2.40)	4	UR



EP211CCT20

FIG. 4 CAMSHAFT & CHAIN

REF. NO.	PART NO.	DESCRIPTION	BR96	REMARKS
1	BR9-12170-00	CAMSHAFT ASSY 1	1	
2	BR9-12180-00	CAMSHAFT ASSY 2	1	
3	93440-41178	CIRCLIP	2	
4	94591-57122	CHAIN	1	
5	BR9-12251-00	DAMPER, CHAIN 1	1	
6	33D-12252-00	DAMPER, CHAIN 2	1	
7	1SL-12233-00	PLATE, GUIDE STOPPER 1	1	
8	90151-06024	SCREW, COUNTERSUNK	1	
9	5TA-12210-30	TENSIONER ASSY, CAM CHAIN	1	
10	5EL-12228-00	.BOLT	1	
11	5EL-12214-00	.GASKET	1	
12	4FM-12213-00	GASKET, TENSIONER CASE	1	
13	90105-06148	BOLT, FLANGE	2	
14	90430-06014	GASKET	1	



FIG. 5 WATER PUMP

REF. NO.	PART NO.	DESCRIPTION	QTY	REMARKS
1	BR9-12450-00	IMPELLER SHAFT ASSY	1	
2	93603-12030	PIN, DOWEL	1	
3	93102-08004	OIL SEAL	1	
4	93102-08307	OIL SEAL	1	
5	93300-60801	BEARING	1	
6	1SL-11917-00	COLLAR	1	
7	93440-07182	CIRCLIP	1	
8	33D-12422-00	COVER, HOUSING	1	
9	33D-12427-00	GASKET, HOUSING COVER 1	1	
10	93604-10011	PIN, DOWEL	2	
11	95022-06025	BOLT, FLANGE	4	
12	95022-06010	BOLT, FLANGE	1	
13	90430-06014	GASKET	1	
14	5BE-12564-00	PIPE, WATER	1	
15	93210-19758	O-RING	1	



EP211CTC50

FIG. 6 RADIATOR & HOSE

REF. NO.	PART NO.	DESCRIPTION	BR96	REMARKS
1	BR9-12482-00	PIPE 2	1	
2	95022-06012	BOLT, FLANGE	1	
3	93210-16500	O-RING	1	
4	1SL-12446-00	JOINT	1	
5	93210-24253	O-RING	1	
6	95022-06020	BOLT, FLANGE	1	
7	BR9-1240A-00	RADIATOR ASSY	1	
8	BR9-12461-00	RADIATOR COMP	1	
9	5SL-12462-00	CAP, RADIATOR	1	
10	33D-12465-00	DAMPER, RADIATOR	2	
11	91A20-05065	TUBE, FLEXIBLE VINYL	1	
12	90467-090A2	CLIP	1	
13	BR9-12576-00	HOSE 1	1	
14	BR9-12577-00	HOSE 2	1	
15	BR9-12578-00	HOSE 3	1	
16	BR9-12579-00	HOSE 4	1	
17	90450-28001	HOSE CLAMP ASSY	2	
18	90450-25001	HOSE CLAMP ASSY	3	
19	90450-22001	HOSE CLAMP ASSY	2	
20	90450-32003	HOSE CLAMP ASSY	1	
21	90480-15012	GROMMET	4	
22	90387-06065	COLLAR	4	
23	90119-06262	BOLT, WITH WASHER	4	

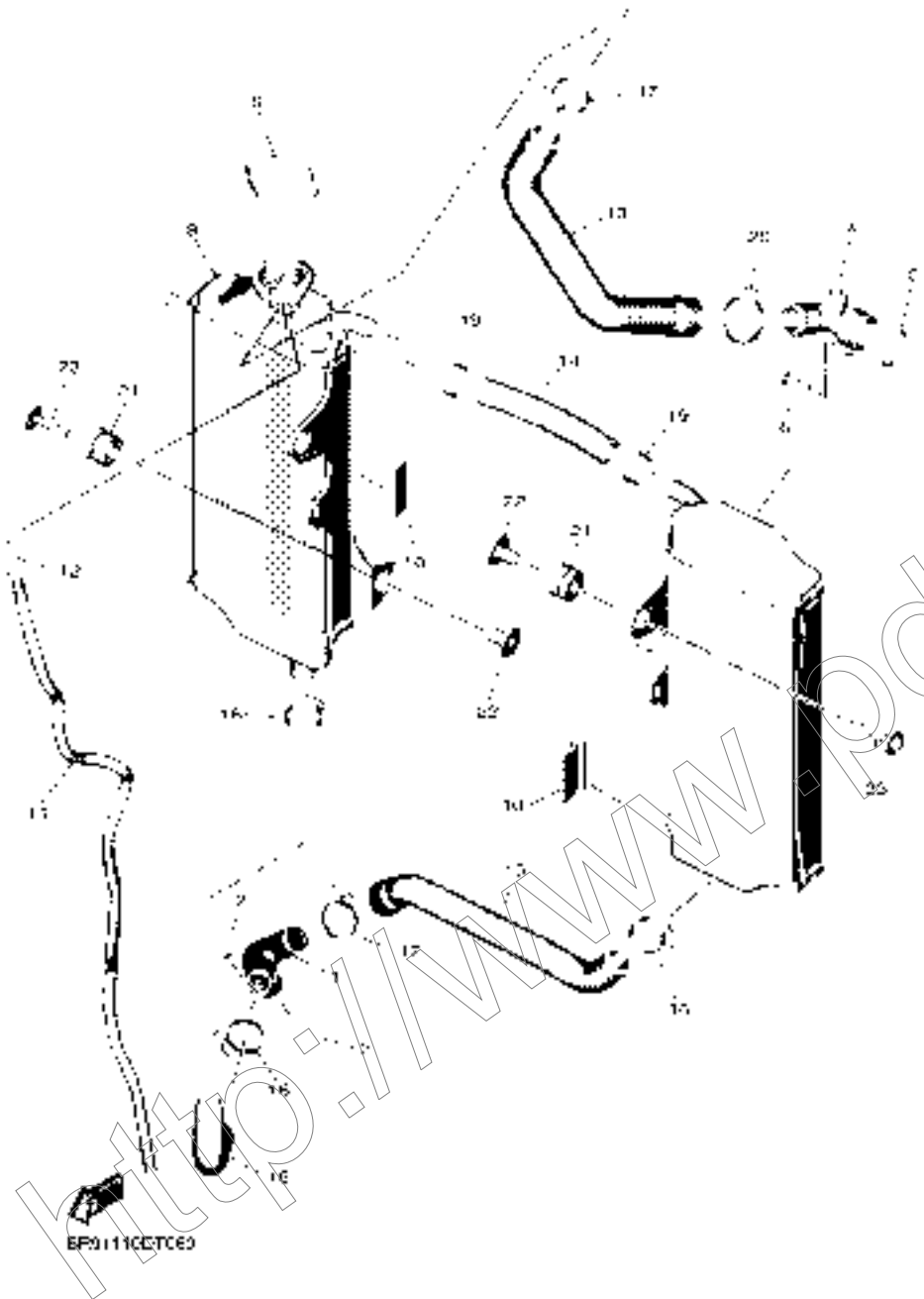

EP9111CCTCE9

FIG. 7 OIL PUMP

REF. NO.	PART NO.	DESCRIPTION	QTY	REMARKS
1	1SL-13300-00	OIL PUMP ASSY	1	
2	90110-05033	BOLT, HEXAGON SOCKET HEAD	2	
3	90430-06156	GASKET	1	
4	1SL-13411-10	STRAINER, OIL	1	
5	93210-12010	O-RING	1	
6	90159-06021	SCREW WITH WASHER	1	

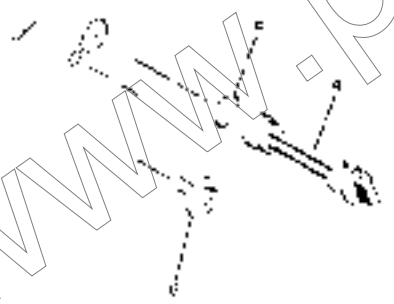
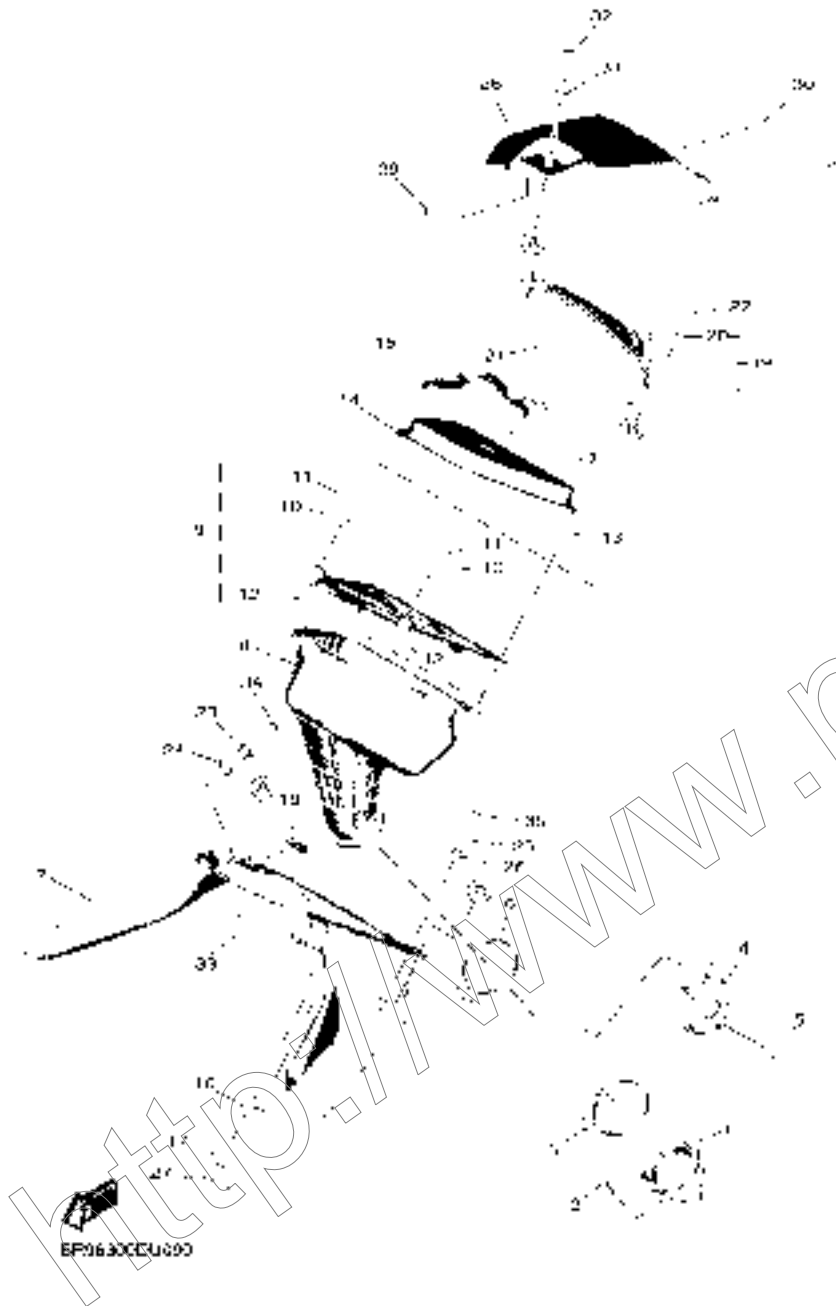

FIG. 9 INTAKE



REF. NO.	PART NO.	DESCRIPTION	BR96				REMARKS
1	BR9-13597-00	JOINT, CARBURETOR 3	1				
2	91312-06020	BOLT, HEXAGON SOCKET HEAD	2				
3	90450-60004	HOSE CLAMP ASSY	1				
4	BR9-14293-00	COVER 1	1				
5	90110-05066	BOLT, HEXAGON SOCKET HEAD	1				
6	90450-58006	HOSE CLAMP ASSY	1				
7	BR9-14411-01	CASE, AIR CLEANER 1	1				
8	BR9-14453-00	JOINT, AIR CLEANER 1	1				
9	BR9-14459-00	HOLDER, GUIDE	1				
10	8GC-14406-00	.HINGE	2				
11	90267-32013	.RIVET, BLIND (3.2X13.5 BLACK)	2				
12	90201-03008	.WASHER, PLATE	2				
13	98502-05014	SCREW, PAN HEAD	7				
14	BR9-14451-00	ELEMENT, AIR CLEANER	1				
15	BR9-14458-00	GUIDE	1				
16	5YU-85886-00	SENSOR, AIR TEMPERATURE	1				
17	97702-50520	SCREW, TAPPING	1				
18	4XV-2177L-01	PLATE, SPRING	1				
19	BR9-14422-00	CAP, CLEANER CASE 2	1				
20	90387-05055	.COLLAR	2				
21	BR9-14462-00	SEAL	1				
22	98502-05014	SCREW, PAN HEAD	2				
23	BR9-14449-00	COLLAR	1				
24	90480-01028	GROMMET	1				
25	90387-06273	COLLAR	2				
26	90480-12237	GROMMET	2				
27	20S-1445C-00	HOLDER	1				

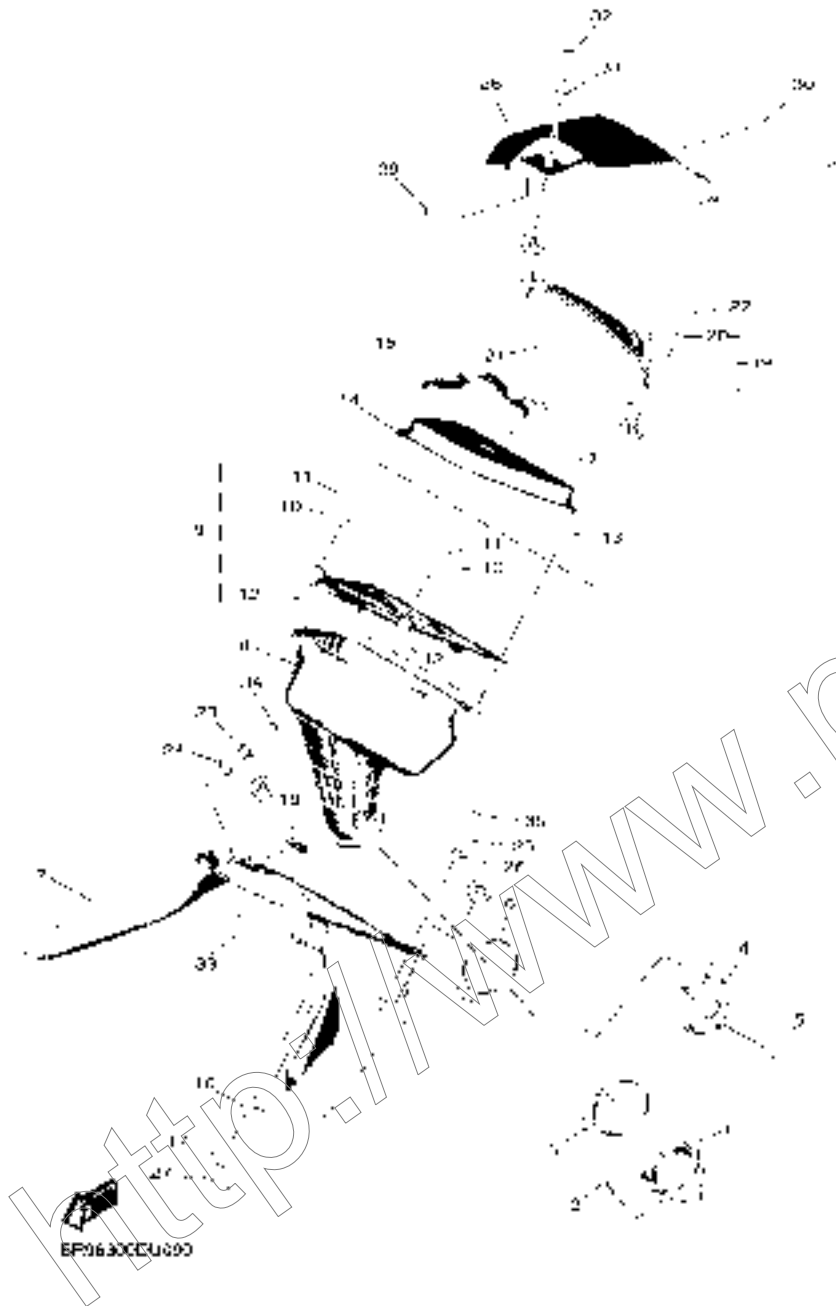
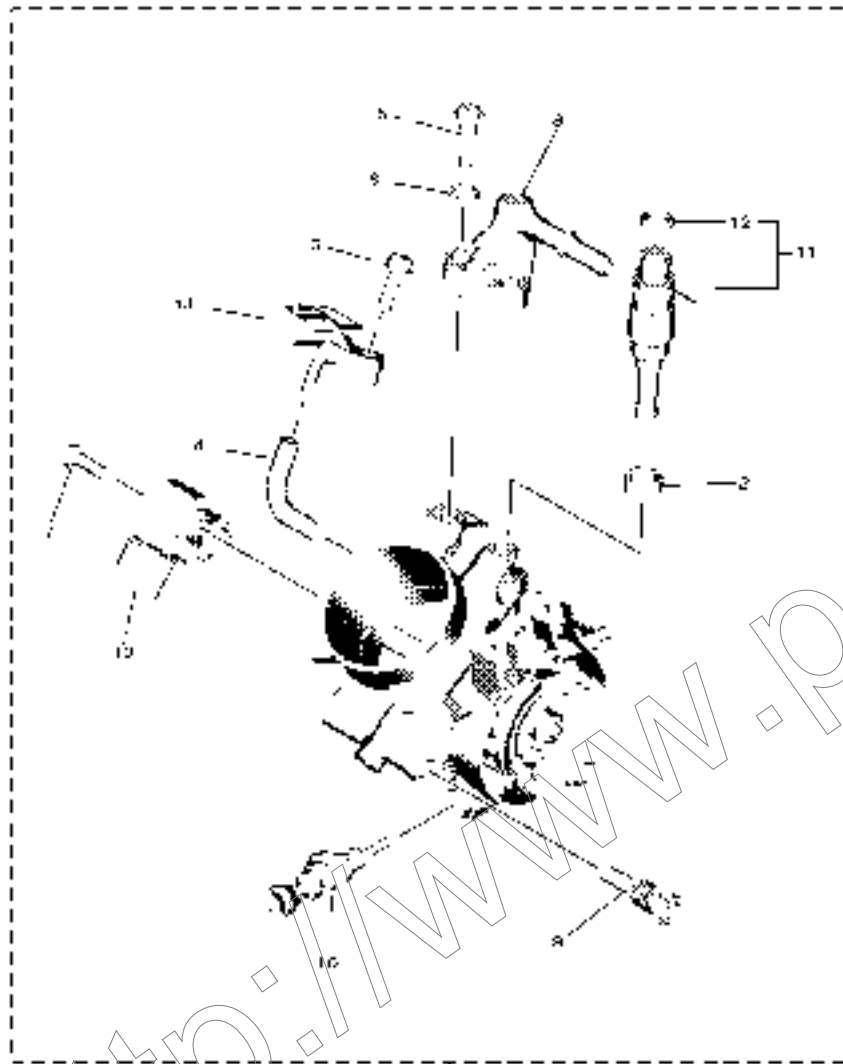

FIG. 9 INTAKE

REF. NO.	PART NO.	DESCRIPTION	BR96	REMARKS
28	BR9-14412-00	CAP, CLEANER CASE 1	1	
29	1SL-14452-00	SEAL	1	
30	BR9-14457-00	SEAL	1	
31	90387-07045	COLLAR	1	
32	1SL-28386-00	HEAD	1	
33	5TJ-21757-00	WASHER, SPECIAL 1	1	
34	90105-06203	BOLT, FLANGE	1	
35	95027-06016	BOLT, FLANGE	2	

FIG. 10 INTAKE 2



REF. NO.	PART NO.	DESCRIPTION	BR96	REMARKS
1	BR9-13750-00	THROTTLE BODY ASSY	1	
2	8FP-13556-00	.RUBBER, INJECTOR	1	
3	2C0-14216-00	.SCREW	1	
4	BR9-14348-00	.PIPE 1	1	
5	BR9-14486-00	.SCREW, ROD	2	
6	363-14198-00	.GASKET	2	
7	8CC-14216-10	.SCREW	1	
8	BR9-13160-00	.DELIVERY PIPE ASSY 1	1	
9	5VX-14503-00	.ADJUST SCREW SET	1	
10	BR9-1410A-00	.STARTER SET	1	
11	3B4-13761-00	.INJECTOR	1	
12	5PS-14147-00	..O-RING	1	
13	BR9-85885-00	.THROTTLE SENSOR ASSY	1	
14	2C0-82380-00	.SENSOR, PRESSURE	1	

FIG. 12 EXHAUST

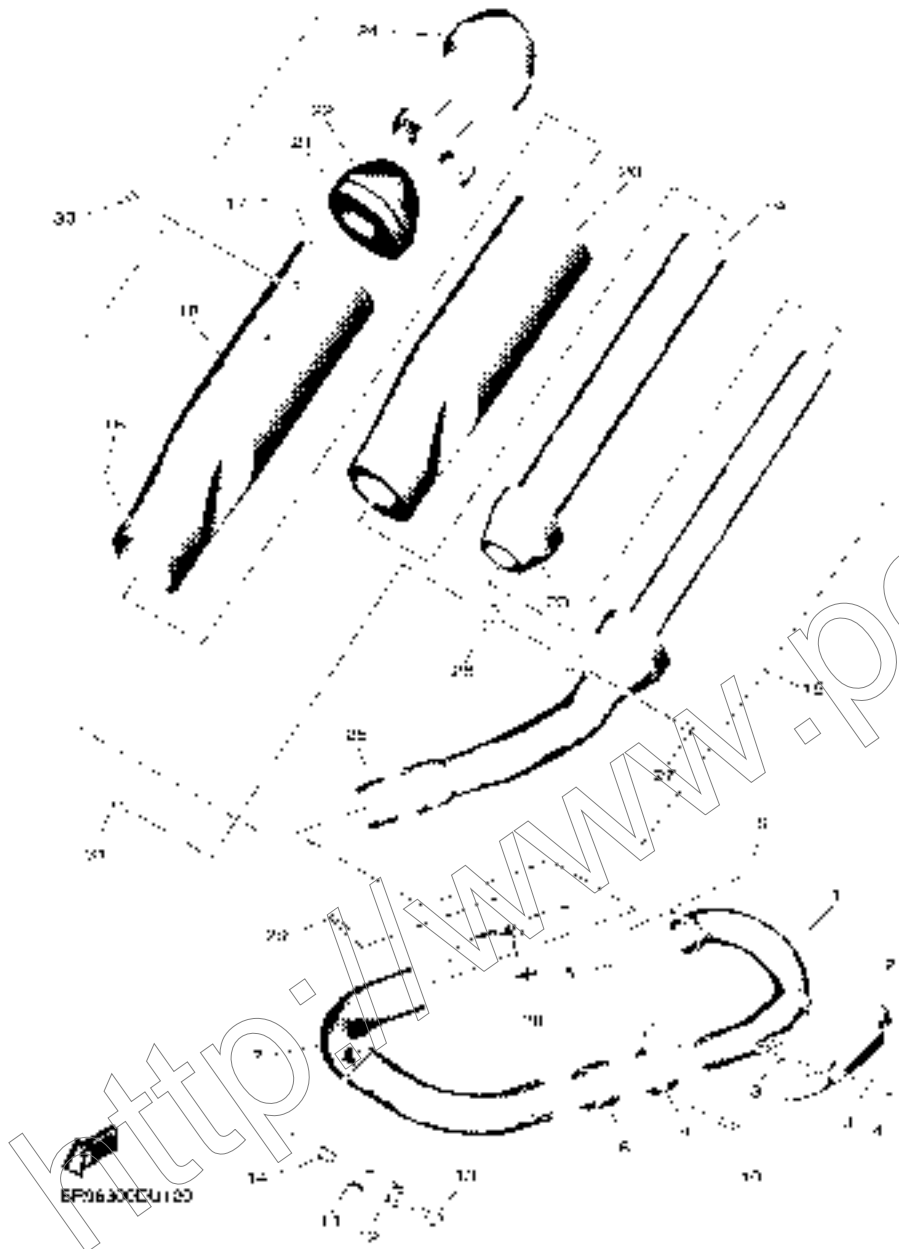

REF. NO.	PART NO.	DESCRIPTION	BR96	REMARKS
1	BR9-14611-00	PIPE, EXHAUST 1	1	
2	1SL-14628-00	PROTECTOR, EXHAUST PIPE	1	
3	90201-05017	WASHER, PLATE	4	
4	98980-06008	SCREW, BIND	2	
5	33D-14613-00	GASKET, EXHAUST PIPE	1	
6	95704-06500	NUT, FLANGE	3	
7	BR9-14621-00	PIPE, EXHAUST 2	1	
8	5PX-14755-00	GASKET, SILENCER	1	
9	1SM-14788-00	BAND, SILENCER	1	
10	95024-08040	BOLT, FLG.(SMALL HEAD)	1	
11	BR9-14639-00	STAY, EXHAUST PIPE 1	1	
12	5VY-14747-00	DAMPER, MUFFLER	1	
13	90119-08174	BOLT, WITH WASHER	1	
14	90387-08081	COLLAR	1	
15	BR9-14750-10	SILENCER ASSY	1	
16	90110-05064	.BOLT, HEXAGON SOCKET HEAD	6	
17	90267-48021	.RIVET, BLIND	8	
18	BR9-1466G-00	.BODY, SILENCER	1	
19	1SL-1469A-10	.FIBER	1	
20	1SL-1477E-00	.FIBER 2	1	
21	1SL-1469F-00	.FIBER	1	
22	1SL-1477G-00	.FIBER 4	1	
23	1SL-1477H-00	.FIBER 5	1	
24	1SL-14798-10	.CAP, SILENCER 2	1	
25	1SL-14714-00	.GASKET, MUFFLER	1	
26	90480-20005	.GROMMET	1	
27	90387-08110	.COLLAR	1	

FIG. 13 CRANKCASE



REF. NO.	PART NO.	DESCRIPTION	BR96	REMARKS
1	BR9-13371-00	PLATE	1	
2	1SL-13475-00	GASKET	1	
3	90105-06203	BOLT, FLANGE	1	
4	90430-06166	GASKET	1	
5	BR9-15100-09	CRANKCASE ASSY	1	
6	99530-14016	.PIN, DOWEL	2	
7	BR9-15155-00	NOZZLE 3	1	
8	90110-06182	BOLT, HEXAGON SOCKET HEAD	1	
9	95022-10016	BOLT, FLANGE	1	
10	90430-10188	GASKET	1	
11	90387-17018	COLLAR	2	
12	90110-06391	BOLT, HEXAGON SOCKET HEAD	5	
13	90110-06363	BOLT, HEXAGON SOCKET HEAD	4	
14	90110-06392	BOLT, HEXAGON SOCKET HEAD	3	
15	BR9-15441-00	HOLDER, CLUTCH CABLE	1	
16	90105-06099	BOLT, FLANGE	2	
17	1SL-15421-00	COVER, CRANKCASE 2	1	
18	1SL-17466-00	GUIDE, CHAIN	1	
19	90105-06189	BOLT, FLANGE	2	
20	1SL-15378-00	HOLDER	1	
21	18P-15383-00	PLATE, BEARING COVER	4	
22	90151-08007	SCREW, COUNTERSUNK	4	
23	4JT-15381-01	PLATE, BEARING COVER	2	
24	90151-06053	SCREW, COUNTERSUNK	2	
25	BR9-15388-00	PLATE, BEARING COVER	1	
26	1SL-18562-00	PLATE, STOPPER 2	1	
27	90110-06182	BOLT, HEXAGON SOCKET HEAD	4	

FIG. 14 CRANKCASE COVER 1

REF. NO.	PART NO.	DESCRIPTION	BR96				REMARKS
1	BR9-15436-00	COVER, STARTING MOTOR	1				
2	90109-060E9	BOLT	1				
3	BR9-15411-00	COVER, CRANKCASE 1	1				
4	90340-36007	PLUG, STRAIGHT SCREW	1				
5	93210-357A3	O-RING	1				
6	90340-14021	PLUG, STRAIGHT SCREW	1				
7	93210-14369	O-RING	1				
8	3Y1-15363-10	PLUG, OIL	1				
9	93210-19123	O-RING	1				
10	BR9-15451-00	GASKET, CRANKCASE COVER 1	1				
11	99530-08016	PIN, DOWEL	2				
12	95022-06030	BOLT, FLANGE	7				
13	95022-06012	BOLT, FLANGE	1				
14	90430-06014	GASKET	2				
15	90465-08062	CLAMP	2				
16	BR9-15431-00	COVER, CRANKCASE 3	1				
17	93101-14164	OIL SEAL	1				
18	90201-15701	WASHER, PLATE (T=1.0)	1				
19	99009-22500	CIRCLIP	1				
20	BR9-15462-00	GASKET, CRANKCASE COVER 3	1				
21	99530-12016	PIN, DOWEL	2				
22	95022-06030	BOLT, FLANGE	11				
23	33D-15415-20	COVER, 1	1				
24	33D-15453-00	GASKET	1				
25	95022-06025	BOLT, FLANGE	5				
26	95022-06070	BOLT, FLANGE	2				



FIG. 15 STARTER CLUTCH

REF. NO.	PART NO.	DESCRIPTION	BR96	REMARKS
1	BR9-15560-00	DAMPER ASSY	1	
2	90201-10045	WASHER, PLATE	1	
3	BR9-15570-10	STARTER CLUTCH ASSY	1	
4	BR9-15378-00	HOLDER	1	
5	91810-18008	.PIN, DOWEL	2	
6	90110-06345	BOLT, HEXAGON SOCKET HEAD	2	

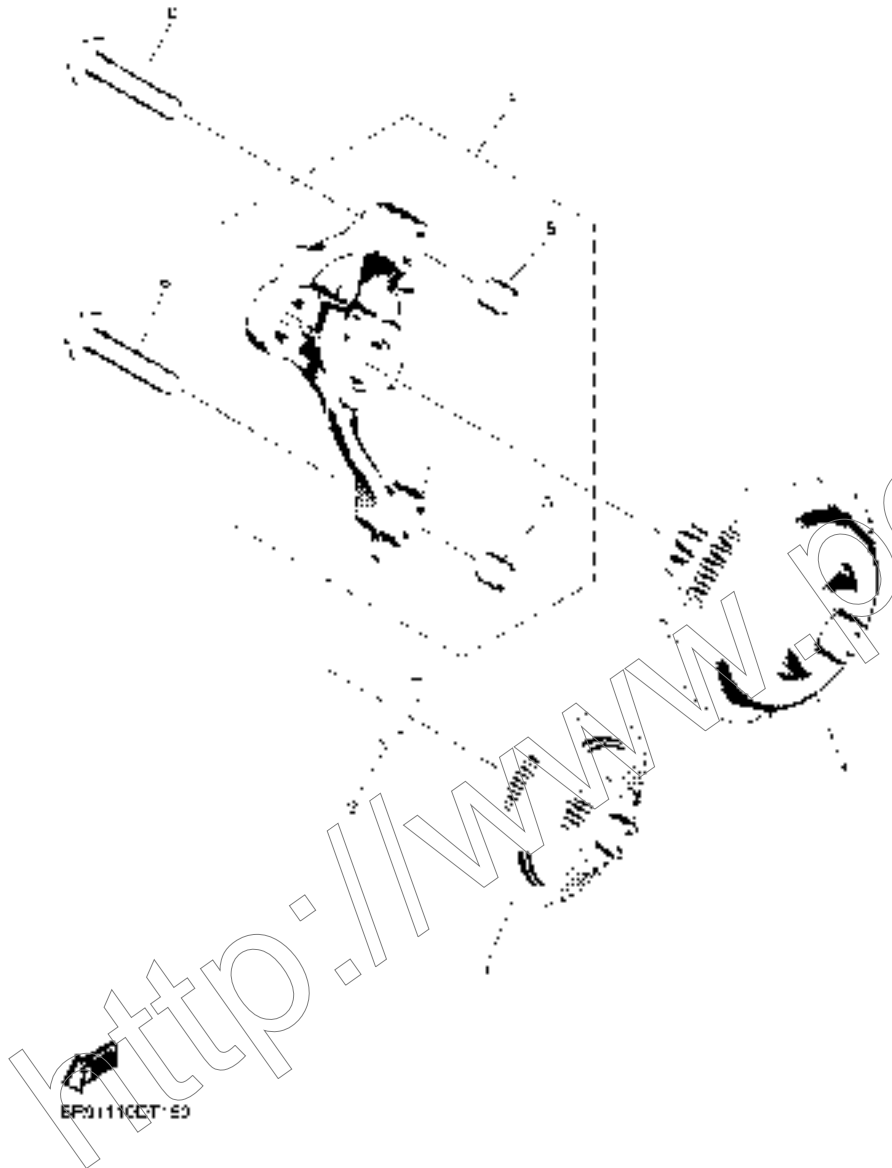

FIG. 16 CLUTCH

REF. NO.	PART NO.	DESCRIPTION	BR96	REMARKS
1	2S2-16111-60	GEAR, PRIMARY DRIVE	1	
2	90208-20007	WASHER, CONICAL SPRING	1	
3	90170-20211	NUT	1	
4	BR9-16150-00	PRIMARY DRIVEN GEAR COMP.	1	
5	5TA-16371-20	BOSS, CLUTCH	1	
6	BR9-16351-00	PLATE, PRESSURE 1	1	
7	BR9-16324-00	PLATE, CLUTCH 1	7	(T1.6)
8	5TA-16321-00	PLATE, FRICTION	5	
9	90501-240A5	SPRING, COMPRESSION	6	
10	90159-06010	SCREW, WITH WASHER	6	
11	5XD-16154-00	PLATE, THRUST 1	1	
12	5VY-16321-00	PLATE, FRICTION	3	
13	90215-20005	WASHER, LOCK	1	
14	90170-20327	NUT	1	
15	BR9-16356-00	ROD, PUSH 1	1	
16	93340-21209	BEARING	1	
17	93440-10085	CIRCLIP	1	
18	93511-32027	BALL	1	
19	1SL-16357-10	ROD, PUSH 2	1	



FIG. 17 TRANSMISSION

REF. NO.	PART NO.	DESCRIPTION	BR96	REMARKS
1	93306-20532	BEARING	1	
2	BR9-17411-00	AXLE, MAIN	1	
3	BR9-17151-00	GEAR, 5TH PINION(21T)	1	
4	90201-253K0	WASHER, PLATE (T=1.0)	1	
5	93440-25084	CIRCLIP	3	
6	BR9-17131-00	GEAR, 3RD PINION(20T)	1	
7	BR9-17141-00	GEAR, 4TH PINION(22T)	1	
8	90387-21005	COLLAR	1	
9	BR9-17121-00	GEAR, 2ND PINION(15T)	1	
10	90209-21332	WASHER	1	
11	93306-00447	BEARING	1	
12	93306-00426	BEARING	1	
13	BR9-17402-00	DRIVE AXLE ASSY	1	
14	2S2-17211-00	GEAR, 1ST WHEEL(27T)	1	
15	90387-20028	COLLAR	1	
16	90201-203E7	WASHER, PLATE	1	
17	BR9-17251-00	GEAR, 5TH WHEEL(20T)	1	
18	93440-25084	CIRCLIP	1	
19	90209-22008	WASHER	1	
20	BR9-17231-00	GEAR, 3RD WHEEL(26T)	1	
21	90201-253K0	WASHER, PLATE (T=1.0)	1	
22	93440-28062	CIRCLIP	1	
23	BR9-17241-00	GEAR, 4TH WHEEL(24T)	1	
24	90209-26348	WASHER	1	
25	BR9-17221-00	GEAR, 2ND WHEEL(23T)	1	
26	90387-28012	COLLAR	1	
27	93306-205A5	BEARING	1	

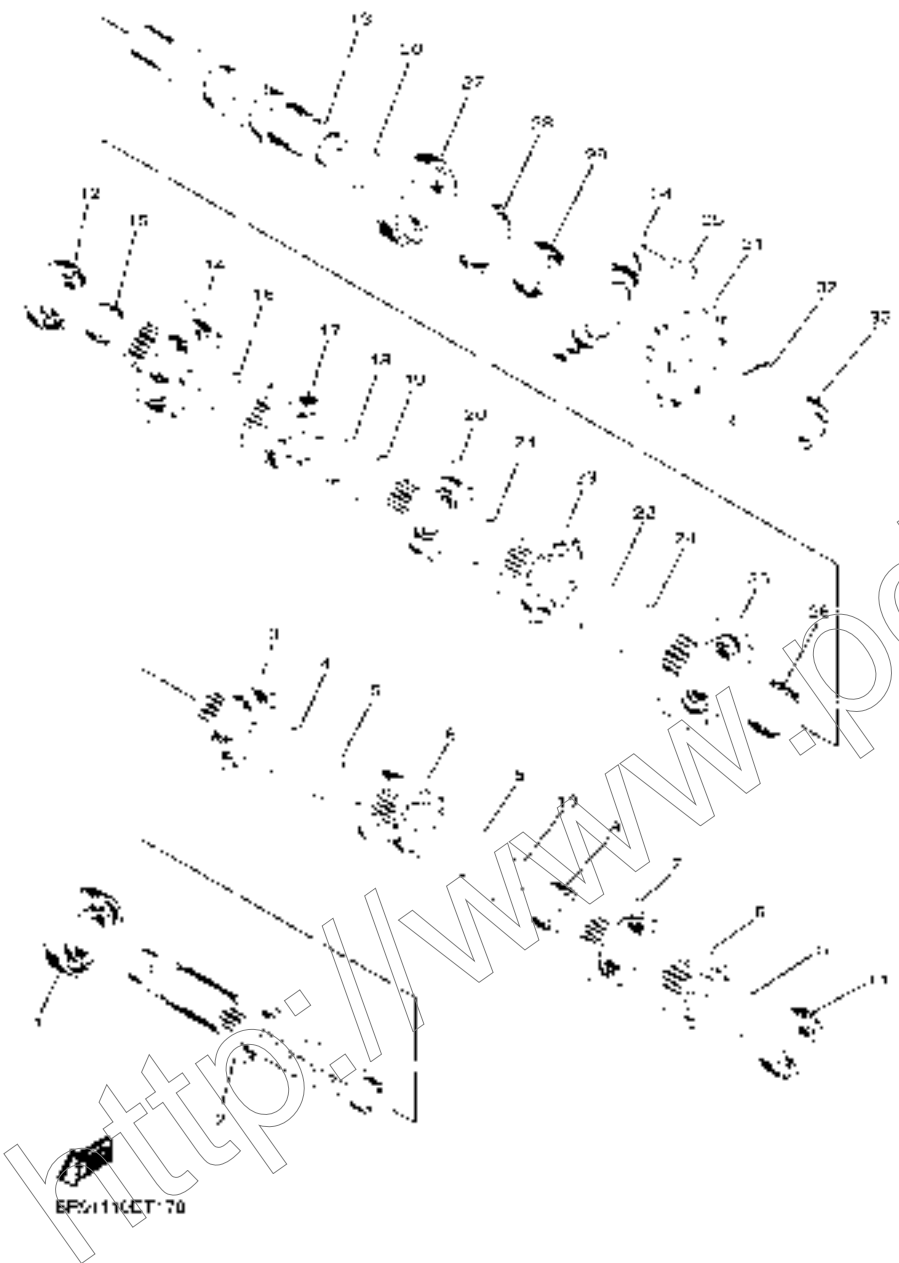

EP2111CT-70

FIG. 18 SHIFT CAM & FORK

REF. NO.	PART NO.	DESCRIPTION	BR96	REMARKS
1	BR9-18541-10	CAM, SHIFT	1	
2	3D7-18542-00	POINT, NEUTRAL	1	
3	90501-06022	SPRING, COMPRESSION	1	
4	93306-90409	BEARING	1	
5	93306-80502	BEARING	1	
6	1SL-18511-00	FORK, SHIFT 1	1	
7	1SL-18512-00	FORK, SHIFT 2	1	
8	1SL-18513-00	FORK, SHIFT 3	1	
9	1SL-18531-00	BAR, SHIFT FORK GUIDE 1	1	
10	1SL-18535-00	BAR, SHIFT FORK GUIDE 2	1	
11	90501-064L1	SPRING, COMPRESSION	4	
12	2GB-18140-10	STOPPER LEVER ASSY	1	
13	90508-29041	SPRING, TORSION	1	
14	90159-06027	SCREW, WITH WASHER	1	
15	33D-18175-00	SPACER	1	

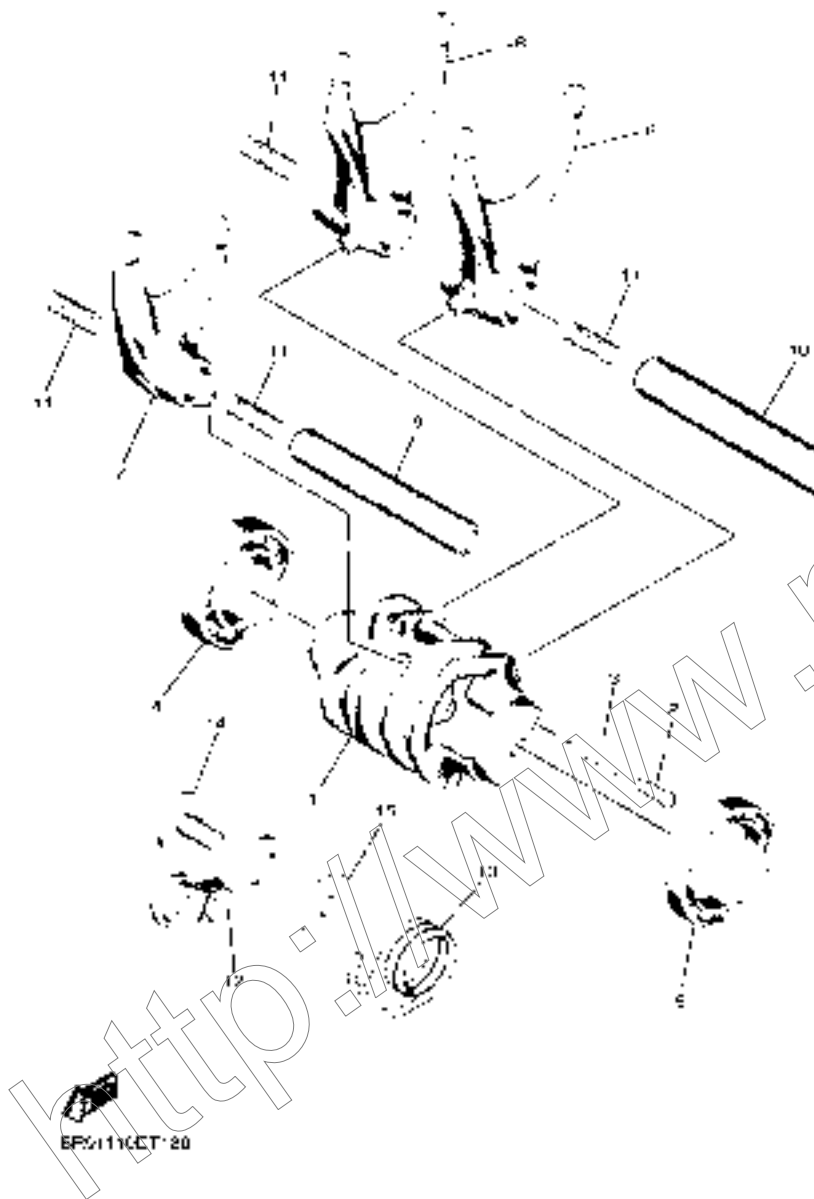

EP2/11CCT'20

FIG. 19 SHIFT SHAFT

REF. NO.	PART NO.	DESCRIPTION	BR96	REMARKS
1	2GB-18185-00	SEGMENT	1	
2	3XJ-18173-10	PIN, SHIFT	1	
3	1SL-18122-10	LEVER, SHIFT 2	1	
4	3XJ-18178-00	ROLLER, SHIFT LEVER	1	
5	3XJ-18182-00	PAWL, SHIFTER	2	
6	90501-052G5	SPRING, COMPRESSION	2	
7	3XJ-18184-00	PIN, PAWL	2	
8	1SL-18172-00	GUIDE, SHIFT	1	
9	90101-06041	BOLT	2	
10	1SL-18101-00	SHIFT SHAFT ASSY	1	
11	90387-14020	COLLAR	1	
12	90508-29023	SPRING, TORSION	1	
13	93608-33002	PIN, DOWEL	1	
14	BR9-18110-00	SHIFT PEDAL ASSY	1	
15	90119-06M12	BOLT, WITH WASHER	1	
16	93109-14010	OIL SEAL	1	



FIG. 20 FRAME

REF. NO.	PART NO.	DESCRIPTION	BR96	REMARKS
1	BR9-21101-10	FRONT FRAME COMP.	1	
2	17D-21447-00	.BRACKET, FOOTREST	1	
3	17D-21448-00	.BRACKET, FOOTREST	1	
4	90149-10031	.SCREW	4	
5	BR9-21190-00	REAR FRAME COMP.	1	
6	90105-08230	BOLT, FLANGE	4	
7	30X-22178-00	TENSIONER	1	
8	4V4-22184-00	BUSH	1	
9	90201-08045	WASHER, PLATE	2	
10	90387-08041	COLLAR	1	
11	95022-08040	BOLT, FLANGE	1	
12	BR9-22178-00	TENSIONER	1	
13	93300-60839	BEARING	1	
14	90387-086N4	COLLAR	1	
15	90105-08232	BOLT, FLANGE	1	
16	90185-08009	NUT, SELF-LOCKING	1	
17	90201-08043	WASHER, PLATE	1	
18	BR9-21149-00	BRACKET, BATTERY BOX	1	
19	90267-32146	RIVET, BLIND	2	
20	90105-10361	BOLT, FLANGE	1	
21	90179-10658	NUT	1	
22	90201-10045	WASHER, PLATE	1	
23	BR9-21417-00	BRACKET, FRONT LOWER 1	2	
24	90105-08143	BOLT, FLANGE	4	
25	90105-10176	BOLT, FLANGE	1	
26	90179-10658	NUT	1	
27	90201-10045	WASHER, PLATE	1	

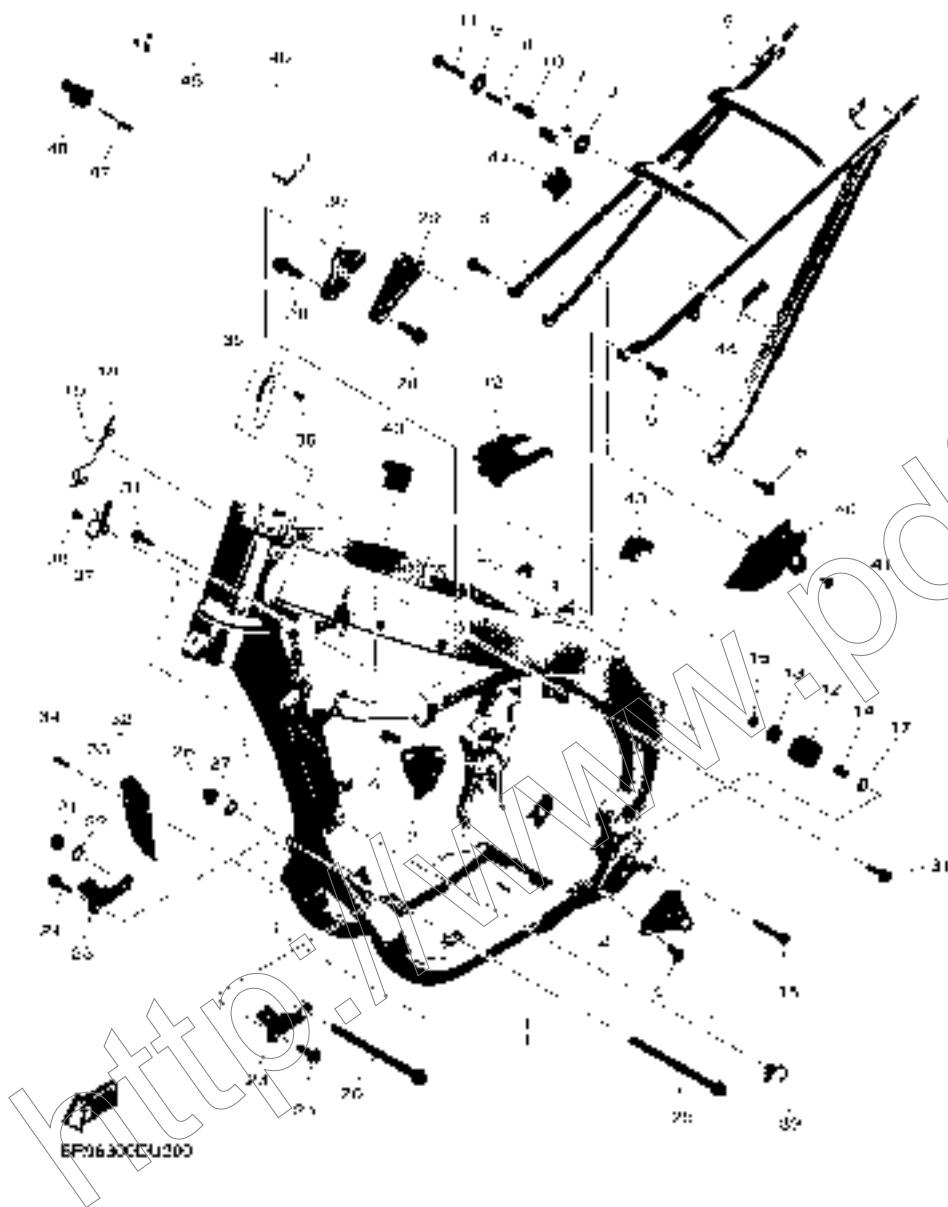

FIG. 20 FRAME

REF. NO.	PART NO.	DESCRIPTION	BR96	REMARKS
28	90105-10189	BOLT, FLANGE	2	
29	BR9-21425-00	BRACKET, REAR UPPER 1	1	
30	BR9-21426-00	BRACKET, REAR UPPER 2	1	
31	90105-08143	BOLT, FLANGE	4	
32	BR9-21471-00	PROTECTOR, ENGINE	1	
33	90387-06106	.COLLAR	1	
34	90105-06170	BOLT, FLANGE	1	
35	1SL-21163-01	HOLDER, CLUTCH CABLE	1	
36	92012-06010	BOLT, BUTTON HEAD	1	
37	B29-21163-00	HOLDER, CLUTCH CABLE	1	
38	92012-06010	BOLT, BUTTON HEAD	1	
39	90464-31002	CLAMP	1	
40	BR9-2171X-01	COVER, SIDE 6	1	
41	90269-06081	RIVET	1	
42	BR9-24181-00	DAMPER, LOCATING 1	1	
43	BR9-24182-00	DAMPER, LOCATING 2	2	
44	BR9-24183-00	DAMPER, LOCATING 3	2	
45	5ET-28166-10	WRENCH, HEXAGON	1	
46	BR9-28199-81	MANUAL, OWNER'S	1	
47	18P-2467E-00	CAP	1	
48	18P-2464V-00	CASE, CAP	1	

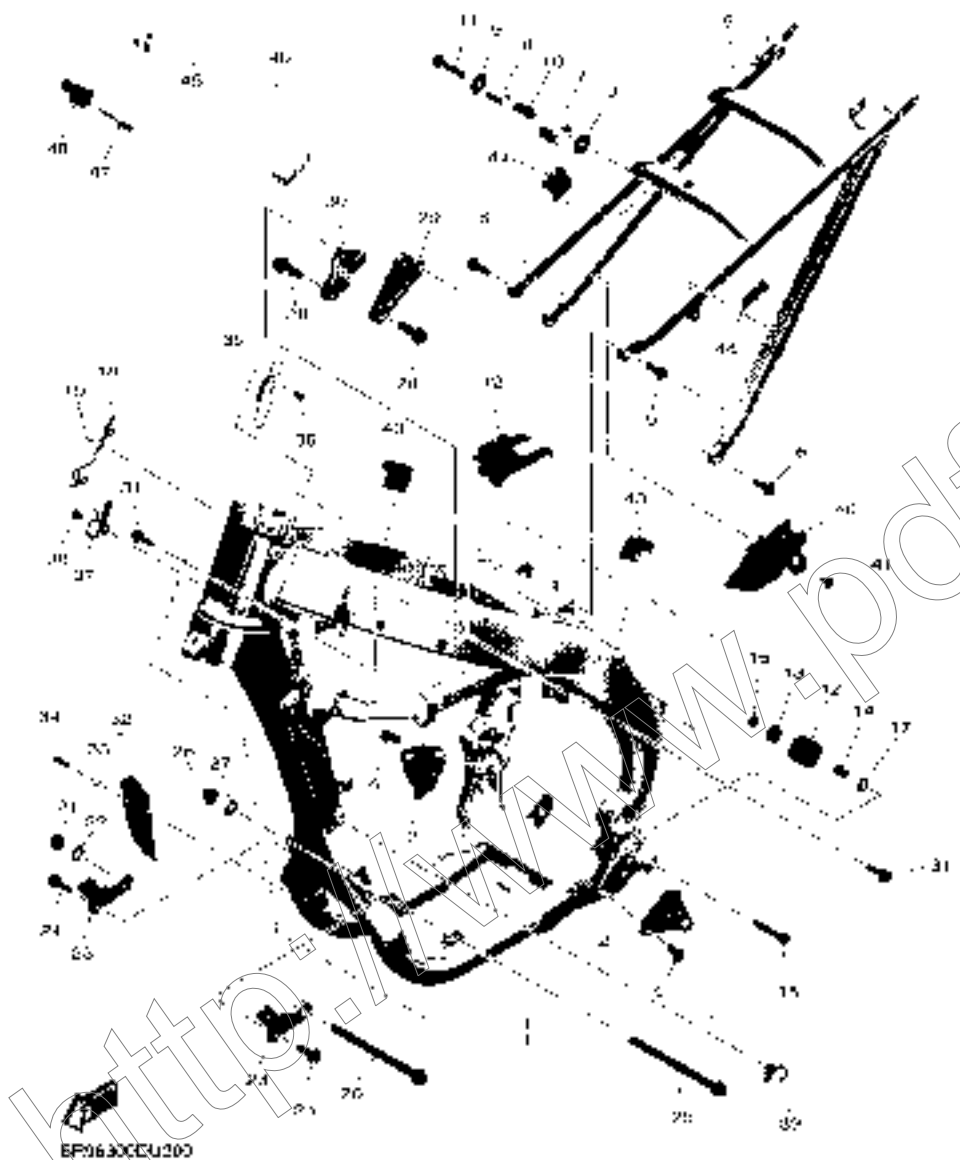
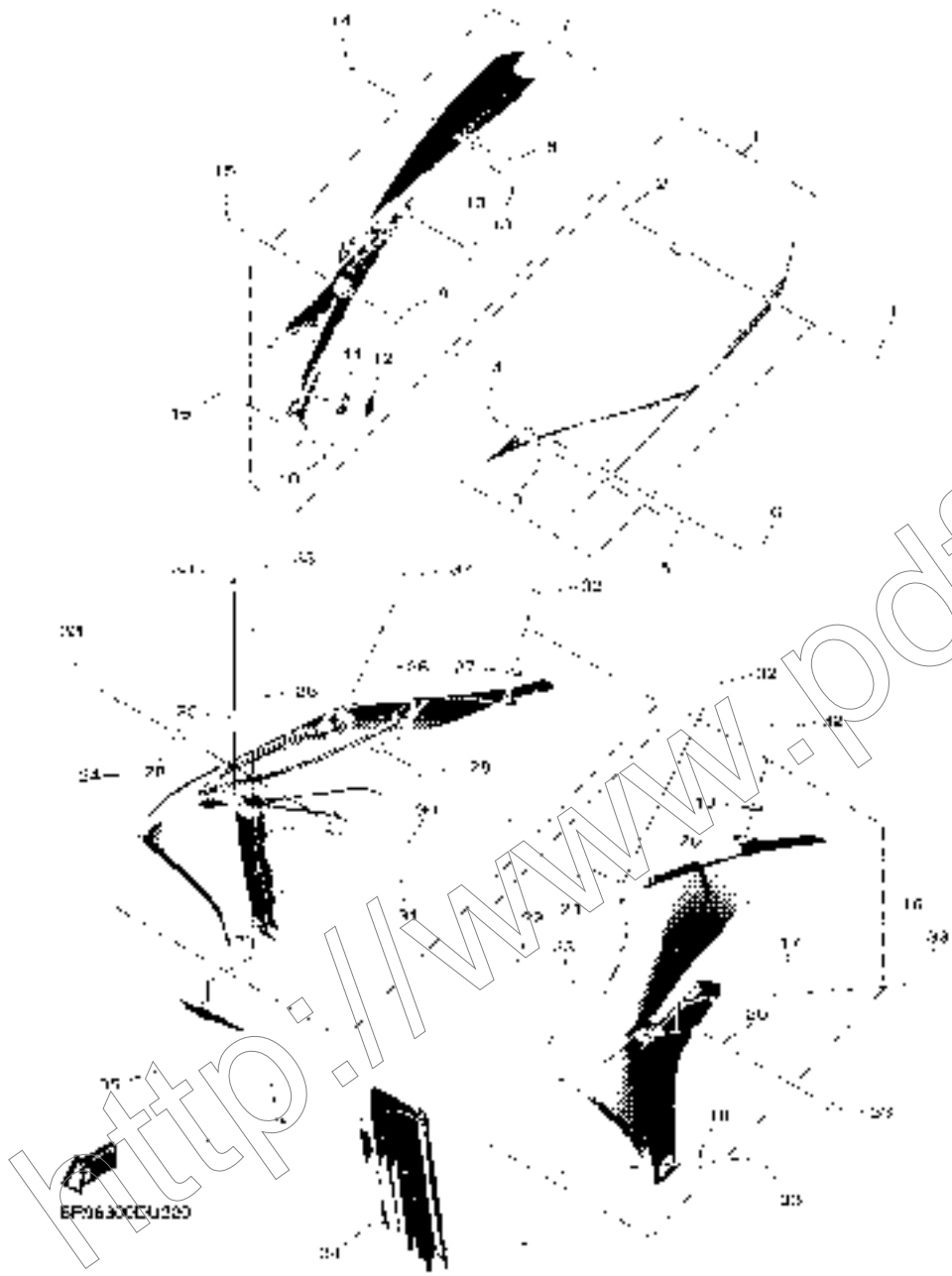

FIG. 22 SIDE COVER



REF. NO.	PART NO.	DESCRIPTION	BR96	REMARKS
1	BR9-21710-00	SIDE COVER ASSY 1	1	
2	90387-08057	.COLLAR	1	
3	5TA-21749-00	.COLLAR	2	
4	90105-08230	BOLT, FLANGE	1	
5	90119-06212	BOLT, WITH WASHER	1	
6	90119-06170	BOLT, WITH WASHER	1	
7	BR9-21720-01	SIDE COVER ASSY 2	1	
8	90387-08057	.COLLAR	1	
9	5BE-21749-00	.COLLAR	1	
10	5TA-21749-00	.COLLAR	1	
11	BR9-21719-00	.GROMMET	1	
12	1DX-21746-01	.DAMPER	1	
13	1SL-21719-00	.GROMMET	2	
14	90105-08230	BOLT, FLANGE	1	
15	90119-06170	BOLT, WITH WASHER	1	
16	BR9-217R0-A0	SIDE COVER INSERT ASSY. 3	1	
	BR9-21730-80	SIDE COVER ASSY 3 (WO/GRAPHIC)	1	AP
17	17D-21749-00	.COLLAR	1	
18	5BE-21749-00	.COLLAR	1	
19	1SL-21748-00	.COLLAR	1	
20	90387-07045	.COLLAR	2	
21	90480-10068	.GROMMET	1	
22	BR9-14467-00	.SEAL	1	
23	BR9-1446R-00	.SEAL	1	
24	BR9-217S0-A0	SIDE COVER INSERT ASSY. 4	1	
	BR9-21740-80	SIDE COVER ASSY 4 (WO/GRAPHIC)	1	AP
25	17D-21749-00	.COLLAR	1	

FIG. 22 SIDE COVER

REF. NO.	PART NO.	DESCRIPTION	BR96	REMARKS
26	5BE-21749-00	.COLLAR	1	
27	1SL-21748-00	.COLLAR	1	
28	90387-07045	.COLLAR	2	
29	90480-10068	.GROMMET	1	
30	BR9-14467-00	.SEAL	1	
31	BR9-1446R-00	.SEAL	1	
32	90105-06064	BOLT, FLANGE	4	
33	90119-06217	BOLT, WITH WASHER	6	
34	BR9-2172A-00	PANEL 1	1	
35	BR9-2172F-00	PANEL 2	1	

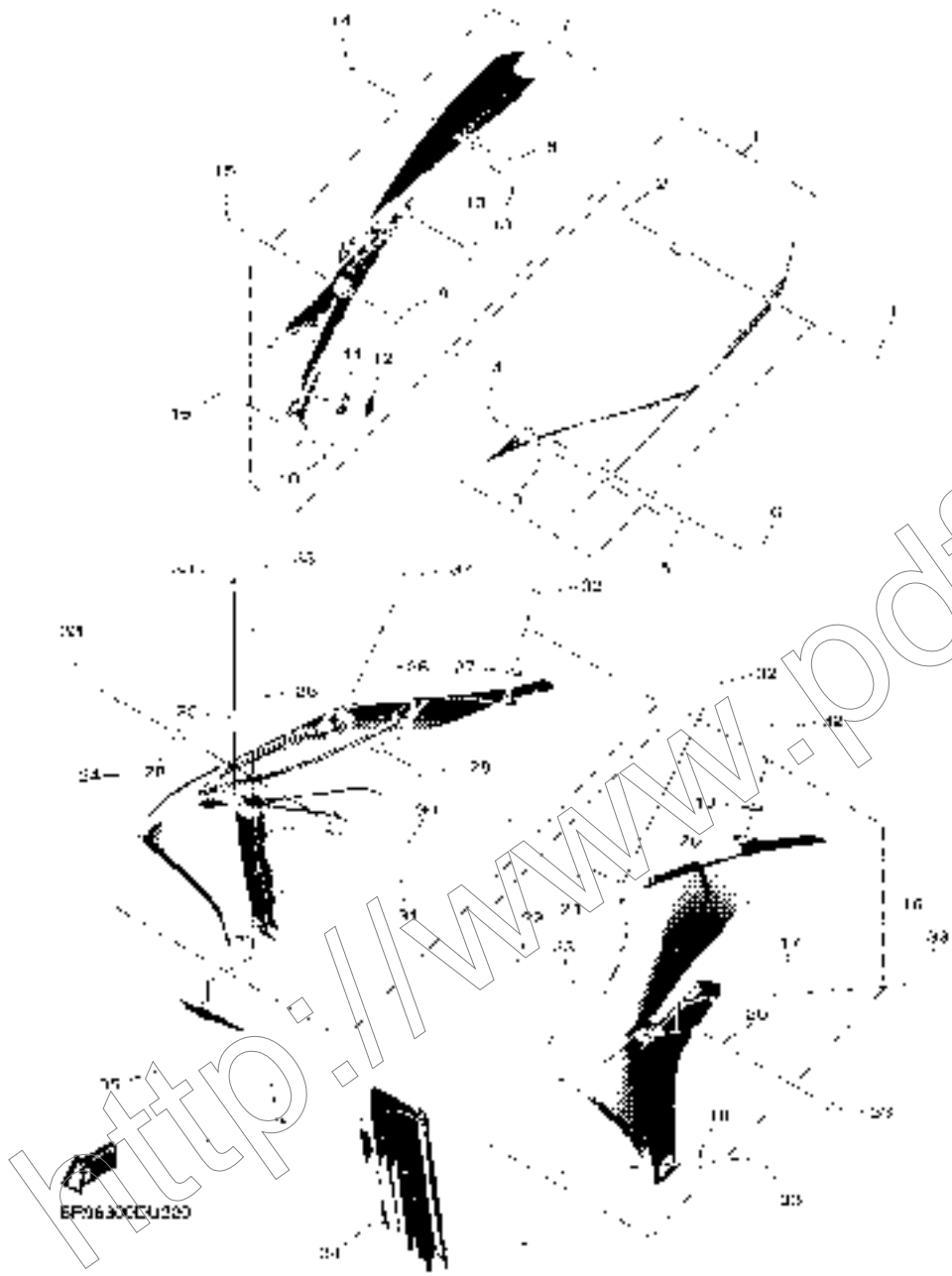
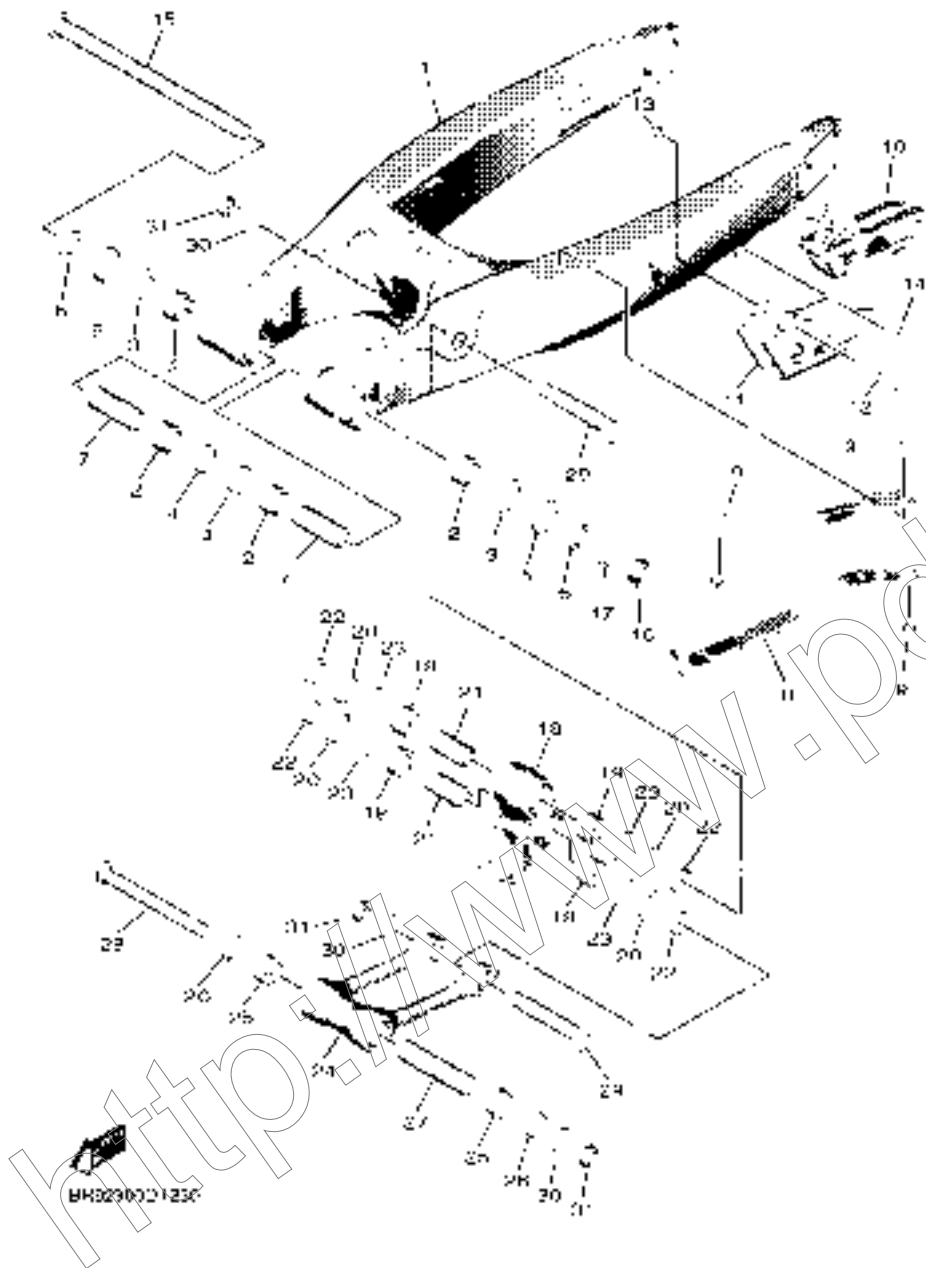
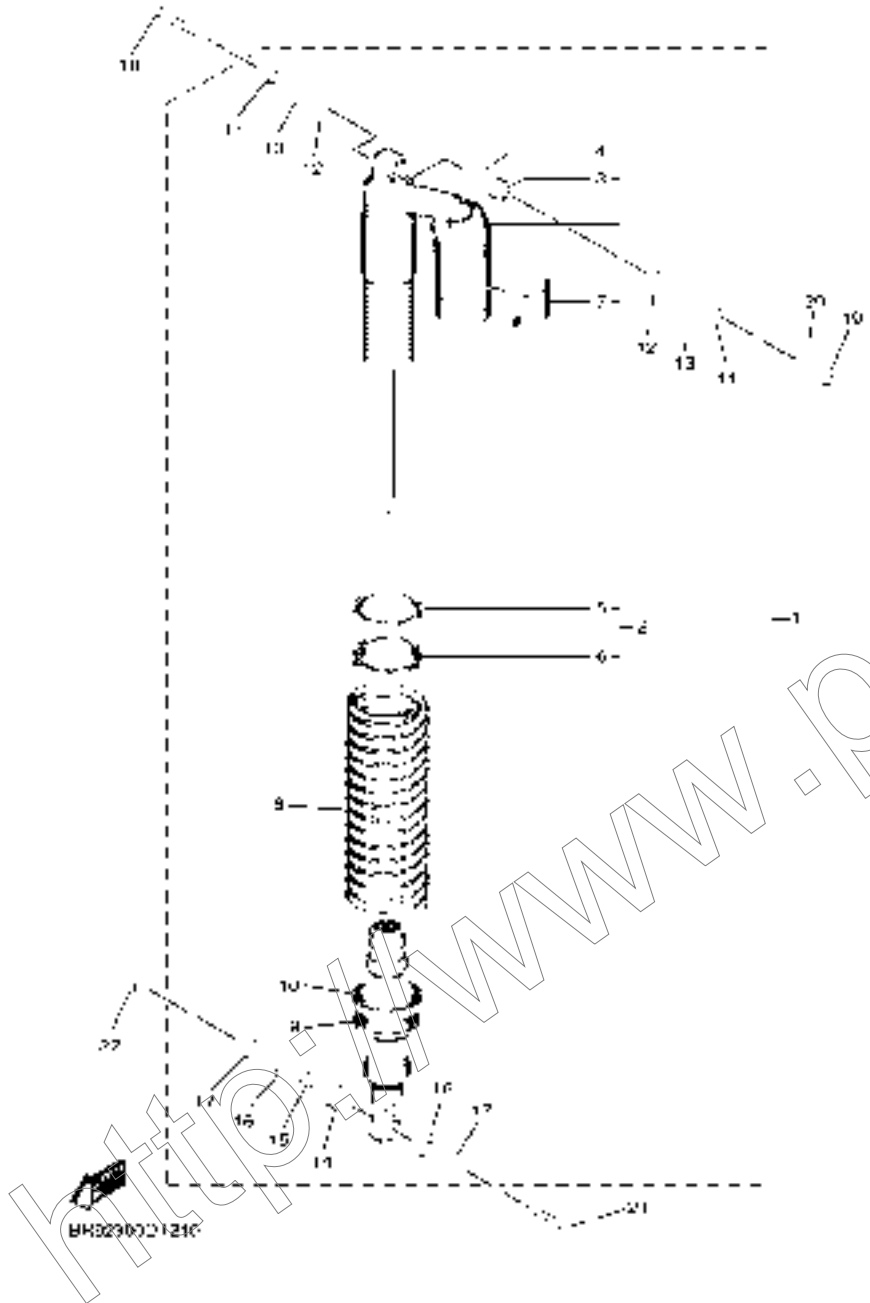

FIG. 23 REAR ARM



REF. NO.	PART NO.	DESCRIPTION	BR96		REMARKS
1	BR9-22110-00	REAR ARM COMP.	1		
2	93317-22262	BEARING	4		
3	93342-22217	BEARING	2		
4	93106-22002	OIL SEAL	2		
5	93109-28043	OIL SEAL	2		
6	90387-17019	COLLAR	2		
7	90387-1714S	COLLAR	2		
8	34P-22151-01	SEAL, GUARD	1		
9	1C3-22969-90	SCREW, 1	3		
10	2S2-22199-70	SUPPORT, CHAIN	1		
11	2S2-22128-70	COVER, THRUST 1	1		
12	90105-06104	BOLT, FLANGE	2		
13	95702-06500	NUT, FLANGE	2		
14	90105-06105	BOLT, FLANGE	1		
15	33D-22141-00	SHAFT, PIVOT	1		
16	90185-16002	NUT, SELF-LOCKING	1		
17	90201-16018	WASHER, PLATE	1		
18	17D-2217A-00	ARM, RELAY	1		
19	93315-32166	BEARING	4		
20	93109-25001	OIL SEAL	4		
21	90387-16026	COLLAR	2		
22	90209-16011	WASHER	4		
23	90201-21014	WASHER, PLATE	4		
24	BR9-2217F-00	ROD, CONNECTING 1	1		
25	93315-32166	BEARING	2		
26	93109-21001	OIL SEAL	2		
27	90387-14016	COLLAR	1		

FIG. 24 REAR SUSPENSION



REF. NO.	PART NO.	DESCRIPTION	BR96	REMARKS
1	BR9-22200-80	SHOCK ABSORBER ASSY, REAR	1	
2	BR9-22201-50	.DAMPER SUB ASSY	1	
3	4JX-22226-00	..BUSH, SHOCK ABSORBER LOWER	1	
4	5DH-23183-00	..CIRCLIP	1	
5	33D-22234-00	..GUIDE, SPRING 3	1	
6	1SL-22213-00	..SEAT, SPRING UPPER	1	
7	4AA-22259-40	..LABEL, WARNING	1	
8	BR9-22212-20	..SPRING (K=56 BLUE)	1	STD
9	33D-22214-00	..GUIDE, SPRING 1	1	
10	33D-22224-00	..GUIDE, SPRING 2	1	
11	1C3-22253-50	..COLLAR, DISTANCE	2	
12	3JE-22475-00	..SEAL, DUST	2	
13	4EW-22474-00	..SEAL, RING	2	
14	5UN-22176-00	..BEARING	1	
15	5MV-22184-00	..BUSH	1	
16	1C3-22253-L1	..COLLAR, DISTANCE	2	
17	5NY-22475-00	..SEAL, DUST	2	
18	5XE-22242-01	BOLT 2	1	
19	95602-10200	NUT, S/L FLANGE	1	
20	92902-10200	WASHER	1	
21	5NY-22241-00	BOLT 1	1	
22	90185-10012	NUT, SELF-LOCKING	1	

FIG. 25 STEERING

REF. NO.	PART NO.	DESCRIPTION	BR96	REMARKS
1	93332-00081	BEARING	1	
2	17D-23389-50	GUIDE, CABLE	1	
3	90105-06170	BOLT, FLANGE	1	
4	90387-06105	COLLAR	1	
5	93332-00068	BEARING	1	
6	17D-23416-50	COVER, BALL RACE 2	1	
7	90179-28015	NUT	1	
8	90201-286K9	WASHER, PLATE (T1.0)	1	
9	1SL-23435-10	CROWN, HANDLE	1	
10	90179-24004	NUT	1	
11	18P-23441-00	HOLDER, HANDLE UPPER	2	
12	BR9-23442-00	HOLDER, HANDLE LOWER	2	
13	1SL-23434-00	HOLDER, DAMPER	4	
14	90201-10035	WASHER, PLATE	2	
15	95602-10200	NUT, S/L FLANGE	2	
16	90105-08154	BOLT, FLANGE	8	
17	BR9-23485-00	PLATE, NUMBER	1	
18	90105-06064	BOLT, FLANGE	1	

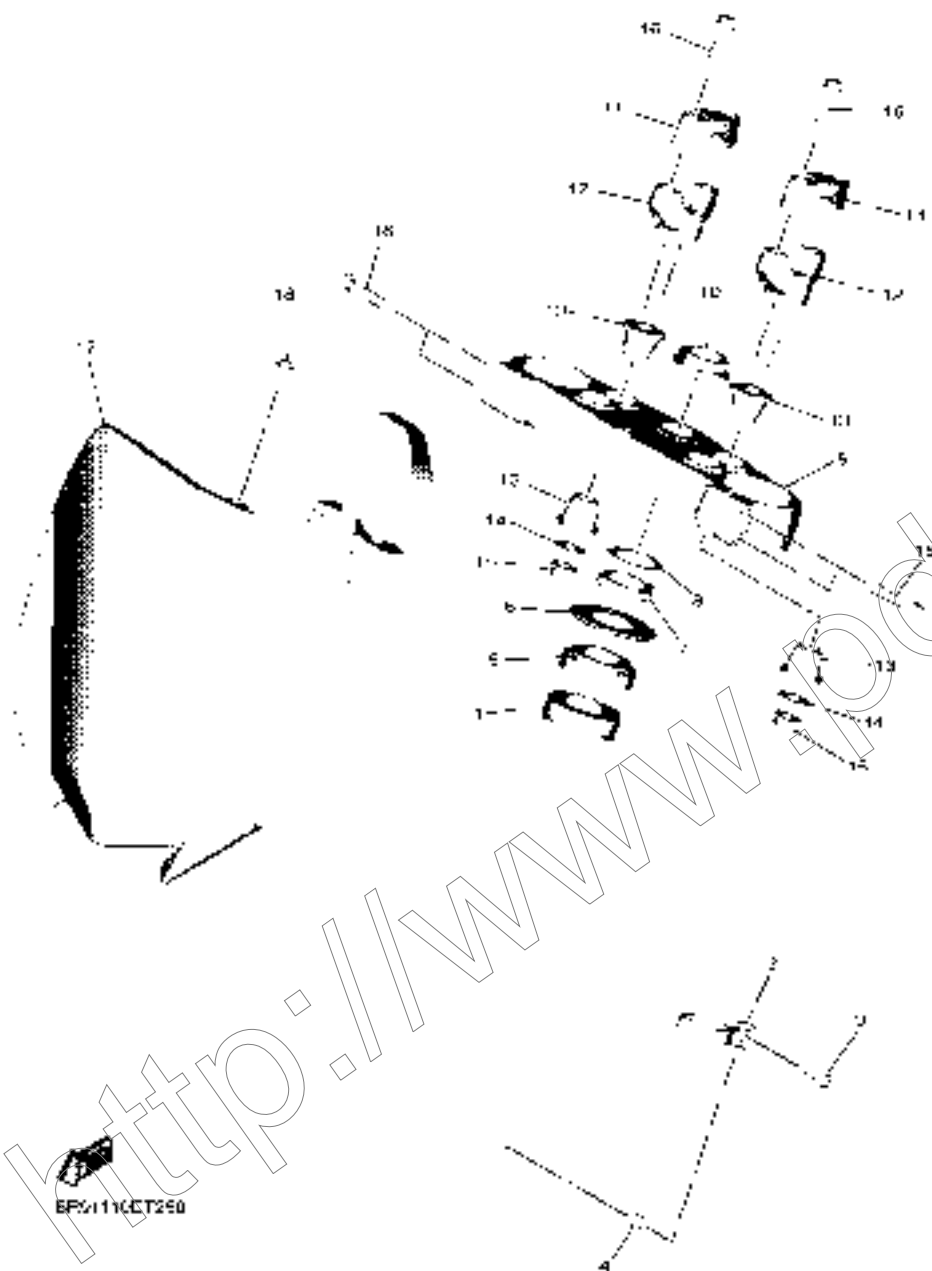

EP2111CT250

FIG. 26 FRONT FORK

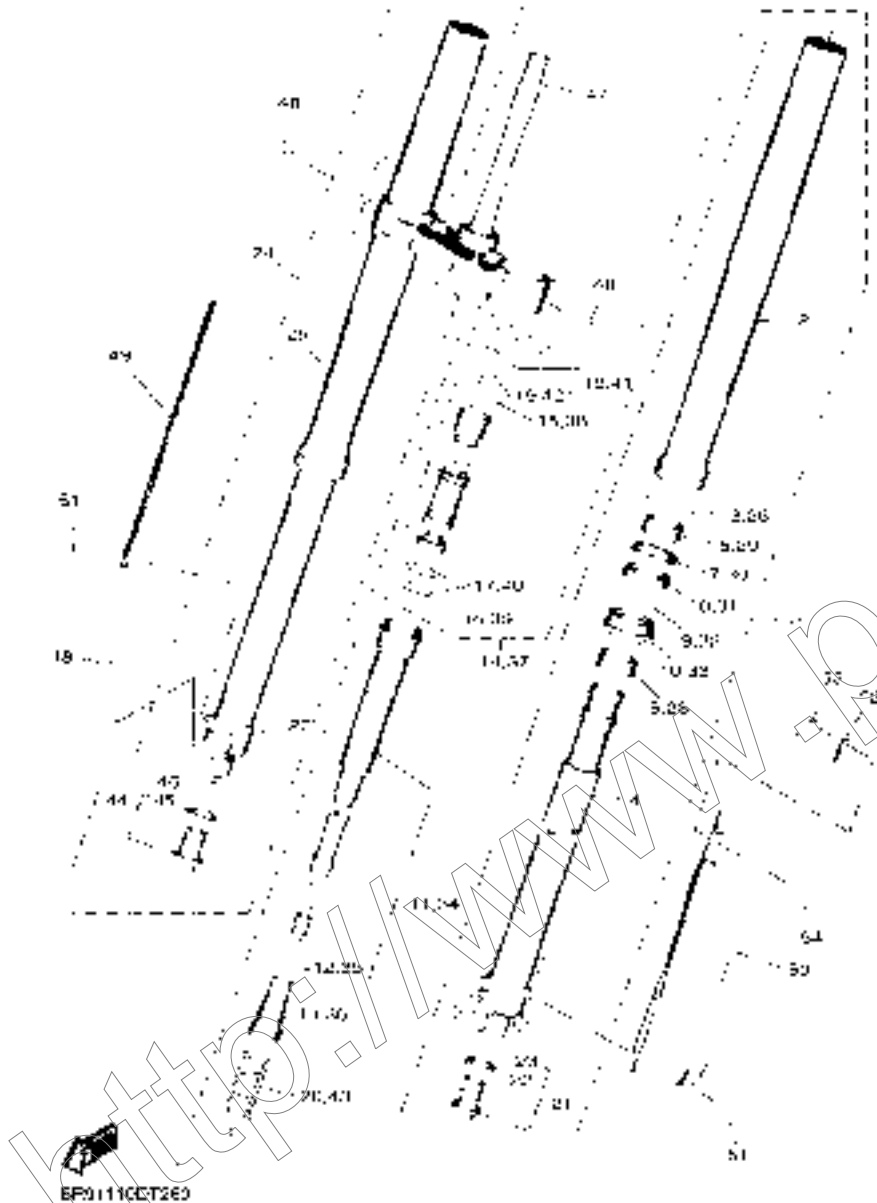

REF. NO.	PART NO.	DESCRIPTION	BR96	REMARKS
1	BR9-23102-30	FRONT FORK ASSY (L.H)	1	
2	33D-23136-00	.TUBE, OUTER	1	
3	17D-23153-00	.RING, SNAP	1	
4	BR9-23120-00	.INNER TUBE COMP.2	1	
5	5XE-23171-L0	.PISTON, FRONT FORK	1	
6	5XE-23125-L0	.METAL, SLIDE 1	1	
7	5XC-23146-10	.WASHER, OIL SEAL	1	
8	B29-23145-00	.OIL SEAL	1	
9	5XE-23153-L0	.RING, SNAP	1	
10	5XE-23144-L0	.SEAL, DUST	1	
11	BR9-23170-30	.CYLINDER COMP., FRONT FORK	1	
12	1C3-23147-L0	..O-RING	1	
13	BR9-23142-01	..SEAT, SPRING UPPER	1	
14	BR9-2316A-30	.VALVE COMP.	1	
15	1C3-23188-L0	..O-RING	1	
16	1C3-23188-P0	..O-RING	1	
17	1AE-23147-00	..O-RING	2	
18	1C3-23190-L0	..AIR VALVE COMP.	1	
19	1C3-23188-R0	...O-RING	1	
20	BR9-23141-00	.SPRING, FRONT FORK (K=5.0)	1	
21	5XC-23111-00	.BOLT, CAP	1	
22	2HH-23158-L0	..GASKET	1	
23	276-23114-00	..GASKET	1	
24	BR9-23103-30	FRONT FORK ASSY (R.H)	1	
25	33D-23136-00	.TUBE, OUTER	1	
26	17D-23153-00	.RING, SNAP	1	
27	BR9-23110-00	.INNER TUBE COMP.1	1	

FIG. 26 FRONT FORK

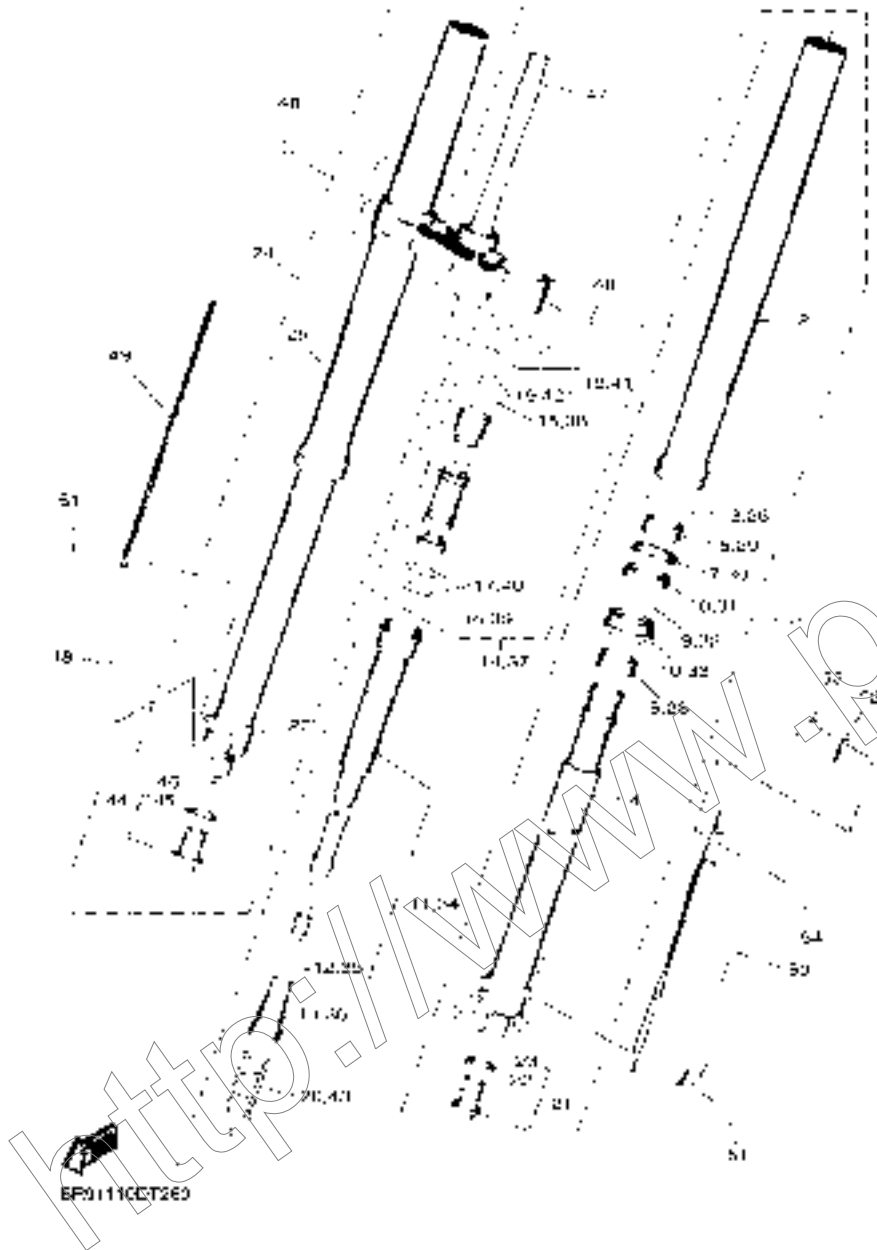

REF. NO.	PART NO.	DESCRIPTION	BR96	REMARKS
28	5XE-23171-L0	.PISTON, FRONT FORK	1	
29	5XE-23125-L0	.METAL, SLIDE 1	1	
30	5XC-23146-10	.WASHER, OIL SEAL	1	
31	B29-23145-00	.OIL SEAL	1	
32	5XE-23153-L0	.RING, SNAP	1	
33	5XE-23144-L0	.SEAL, DUST	1	
34	BR9-23170-30	.CYLINDER COMP., FRONT FORK	1	
35	1C3-23147-L0	..O-RING	1	
36	BR9-23142-01	..SEAT, SPRING UPPER	1	
37	BR9-2316A-30	.VALVE COMP.	1	
38	1C3-23188-L0	..O-RING	1	
39	1C3-23188-P0	..O-RING	1	
40	1AE-23147-00	..O-RING	2	
41	1C3-23190-L0	..AIR VALVE COMP.	1	
42	1C3-23188-R0	...O-RING	1	
43	BR9-23141-00	.SPRING, FRONT FORK (K=5.0)	1	
44	5XC-23111-00	.BOLT, CAP	1	
45	2HH-23158-L0	..GASKET	1	
46	276-23114-00	..GASKET	1	
47	33D-23340-20	UNDER BRACKET COMP.	1	
48	90105-08154	BOLT, FLANGE	8	
49	17D-2315J-50	PROTECTOR 2	1	
50	17D-2315H-50	PROTECTOR 1	1	
51	90109-06232	BOLT	6	
52	17D-23466-00	CLAMP	1	
53	17D-23467-00	CLAMP	1	
54	90105-06170	BOLT, FLANGE	2	

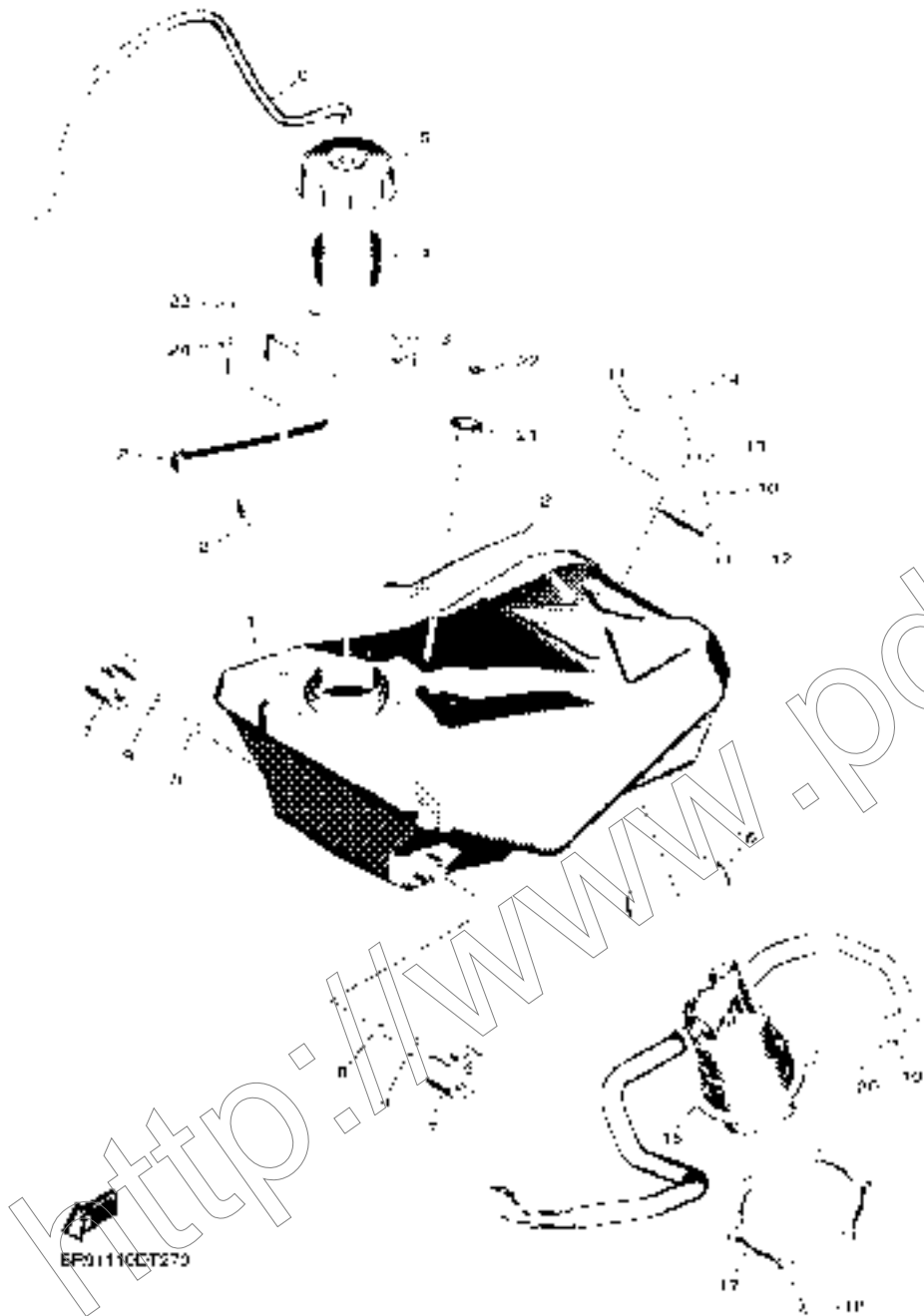

FIG. 27 FUEL TANK

REF. NO.	PART NO.	DESCRIPTION	BR96	REMARKS
1	BR9-24110-00	FUEL TANK COMP.	1	
2	2D1-2414R-00	DAMPER, PLATE 6	3	
3	BR9-24188-01	MOLD, FUEL TANK	1	
4	BR9-24114-00	TUBE, FILLER	1	
5	BR9-24610-00	CAP ASSY	1	
6	90445-09008	HOSE (L470)	1	
7	BR9-24191-00	BRACKET, FUEL TANK 1	2	
8	90105-06203	BOLT, FLANGE	2	
9	90387-06170	COLLAR	2	
10	BR9-2419A-00	HOLDER	1	
11	90105-06064	BOLT, FLANGE	2	
12	90387-066Y6	COLLAR	1	
13	90480-10289	GROMMET	1	
14	90119-06271	BOLT, WITH WASHER	1	
15	33D-13907-01	FUEL PUMP COMP.	1	
16	33D-24486-00	O-RING	1	
17	BR9-24491-00	BRACKET, FUEL PUMP	1	
18	90110-05058	BOLT, HEXAGON SOCKET HEAD	6	
19	BR9-13971-00	PIPE, FUEL 1	1	
20	33D-24135-00	CLAMP 1	1	
21	4EW-2412F-00	BRACKET, SEAT	1	
22	90151-06005	SCREW, COUNTERSUNK	1	
23	90111-06171	BOLT, HEX. SOCKET BUTTON	2	
24	90387-06284	COLLAR	2	



FIG. 29 FRONT WHEEL

REF. NO.	PART NO.	DESCRIPTION	BR96	REMARKS
1	1SL-25111-00	HUB, FRONT	1	
2	93306-97203	BEARING	2	
3	1SL-25117-00	SPACER, BEARING	1	
4	93102-30014	OIL SEAL	2	
5	94416-21059	RIM (1.60-21)	1	
6	5NY-25104-00	SPOKE SET, FRONT	1	
7	*	TIRE (80/100-21 51M MST)	1	LM PIRELLI
8	*	TUBE (80/100-21)	1	LM PIRELLI
9	*	BAND, RIM (80/100-21)	1	LM PIRELLI
10	5SF-25394-00	SPACER, BEAD	1	
11	1SL-25181-00	AXLE, WHEEL	1	
12	BR9-25183-00	COLLAR, WHEEL	1	
13	1SL-25186-00	COLLAR, WHEEL	1	
14	90179-18011	NUT	1	

FIG. 30 FRONT BRAKE CALIPER

REF. NO.	PART NO.	DESCRIPTION	BR96				REMARKS
1	B11-2581T-00	DISK BRAKE ASSY	1				
2	90151-06051	SCREW, COUNTERSUNK	6				
3	B11-2580T-00	CALIPER ASSY (LEFT)	1				
4	5XC-25802-00	.PISTON ASSY, CALIPER	1				
5	5KM-25803-10	..CALIPER SEAL KIT	1				
6	5DH-25919-00	..SUPPORT, PAD	1				
7	1UY-25824-51	..SCREW, BLEED	1				
8	1UY-25825-51	..CAP	1				
9	B29-25805-00	..BRAKE PAD KIT	1				
10	5DH-25933-00	..PIN, PAD	1				
11	5DH-25916-00	..PLUG	1				
12	3SP-25926-51	..BOLT	1				
13	3SP-25914-51	..PIN, SLIDE	1				
14	3JD-25917-00	..BOOT, CALIPER	1				
15	1UY-25937-51	..BOOT 2	1				
16	5XC-25849-G0	..RETAINER, CALIPER	1				
17	90105-08137	BOLT, FLANGE	2				

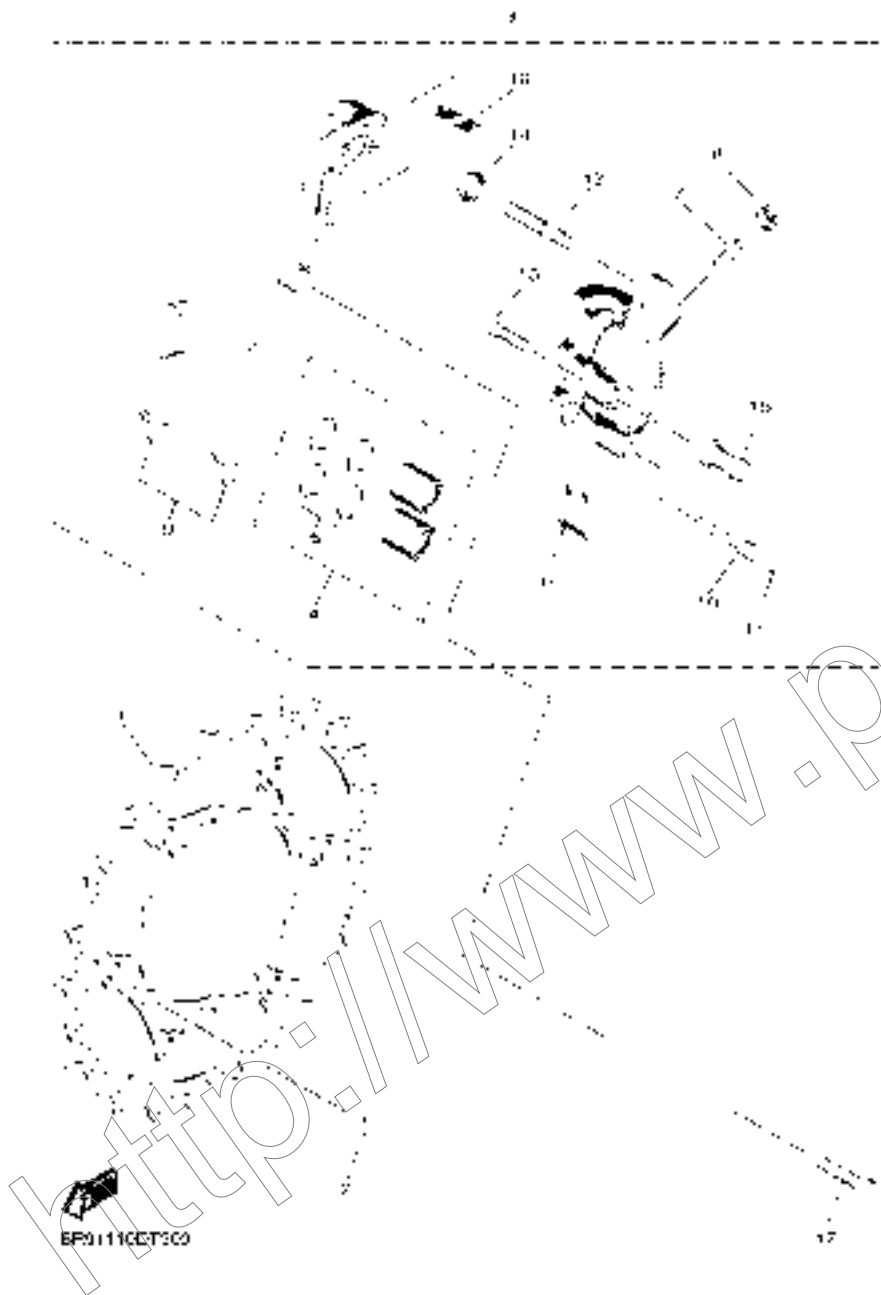

FIG. 31 REAR WHEEL

REF. NO.	PART NO.	DESCRIPTION	BR96	REMARKS
1	17D-25311-00	HUB, REAR	1	
2	17D-25317-00	SPACER, BEARING	1	
3	93306-90510	BEARING	3	
4	93102-32337	OIL SEAL	2	
5	99009-42700	CIRCLIP	1	
6	17D-25448-50	SPROCKET, DRIVEN (48T)	1	STD
	17D-25447-50	SPROCKET, DRIVEN (47T)	1	AP
	17D-25449-50	SPROCKET, DRIVEN (49T)	1	AP
	17D-25450-50	SPROCKET, DRIVEN (50T)	1	AP
	17D-25451-50	SPROCKET, DRIVEN (51T)	1	AP
	17D-25452-50	SPROCKET, DRIVEN (52T)	1	AP
7	90109-081G1	BOLT	6	
8	90185-08008	NUT, SELF-LOCKING	6	
9	90201-08043	WASHER, PLATE	6	
10	34P-25304-00	SPOKE SET, REAR	1	
11	94421-19018	RIM (2.15-19)	1	
12	*	TIRE (110/90-19 62M NHS)	1	LM PIRELLI
13	*	TUBE (110/90-19)	1	LM PIRELLI
14	*	BAND, RIM (3.50-18)	1	LM PIRELLI
15	3JE-25394-00	SPACER, BEAD	1	
16	4XM-25364-00	DAMPER	1	
17	90480-08608	GROMMET	1	
18	BR9-2530S-00	COLLAR ASSY	2	
19	1SL-25388-00	PULLER, CHAIN 1	1	
20	1SL-25389-00	PULLER, CHAIN 2	1	
21	90101-08006	BOLT	2	
22	90179-08019	NUT	2	

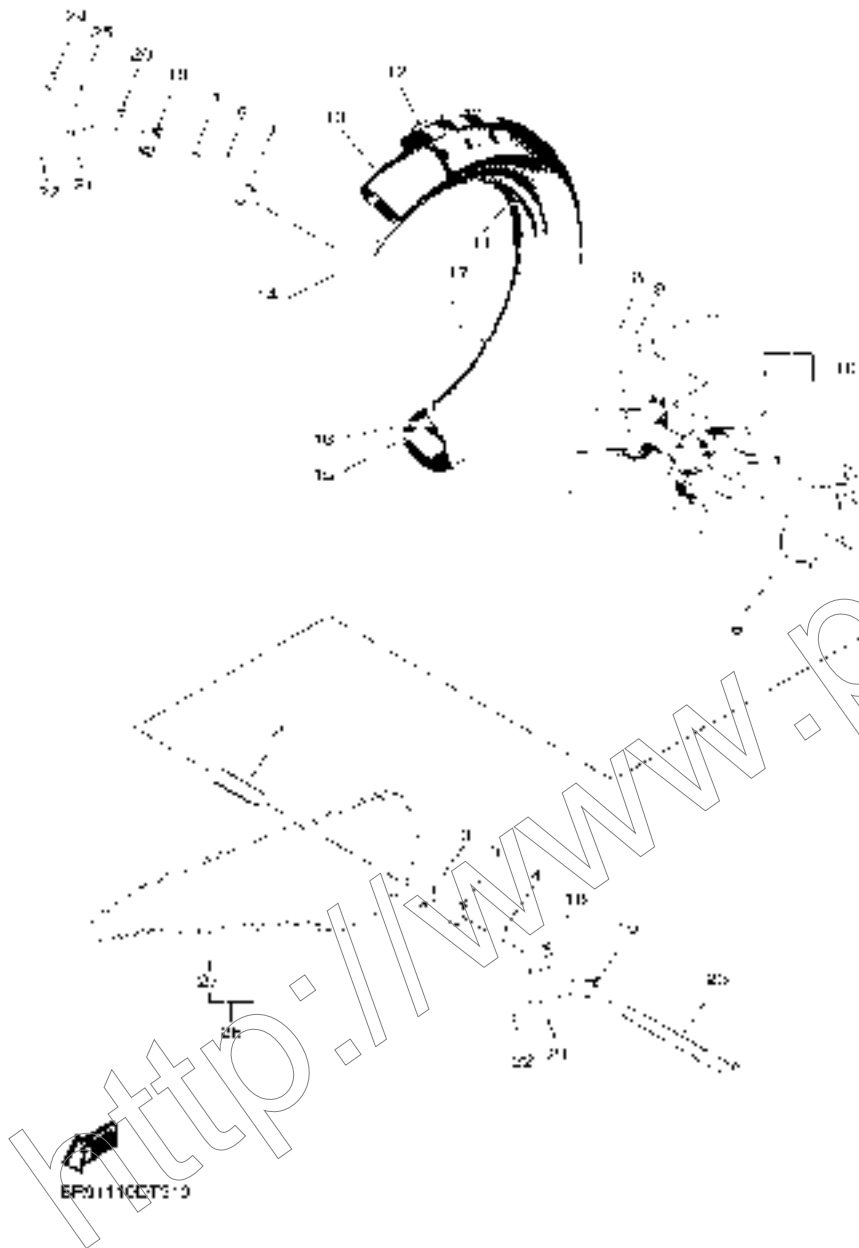

FIG. 32 REAR BRAKE CALIPER

REF. NO.	PART NO.	DESCRIPTION	BR96	REMARKS
1	B11-2582W-10	DISK, REAR BRAKE 2	1	
2	90151-06051	SCREW, COUNTERSUNK	6	
3	17D-2580W-11	CALIPER ASSY, REAR 2	1	
4	5UN-W0057-50	.PISTON ASSY, CALIPER	1	
5	5UN-W0047-50	..CALIPER SEAL KIT	1	
6	5DH-25919-50	..SUPPORT, PAD	1	
7	1UY-25824-51	..SCREW, BLEED	1	
8	1UY-25825-51	..CAP	1	
9	1C3-W0046-B0	..BRAKE PAD KIT 2	1	
10	5UN-25828-60	..SHIM, CALIPER	1	
11	5UN-25827-60	..SHIM, CALIPER	1	
12	5UN-22898-60	..INSULATOR, HEAT	2	
13	8CR-25924-00	..PIN, PAD	1	
14	5DH-25916-00	..PLUG	1	
15	5DH-25914-50	..PIN, SLIDE	1	
16	3JD-25917-00	..BOOT, CALIPER	1	
17	5UN-25914-00	..PIN, SLIDE	1	
18	1UY-25937-51	..BOOT 2	1	
19	5UN-25913-00	..RETAINER	1	
20	17D-25718-50	PROTECTOR, DISK BRAKE	1	
21	90105-06110	BOLT, FLANGE	2	
22	17D-27491-50	PROTECTOR	1	
23	90105-06110	BOLT, FLANGE	1	
24	90105-06111	BOLT, FLANGE	1	

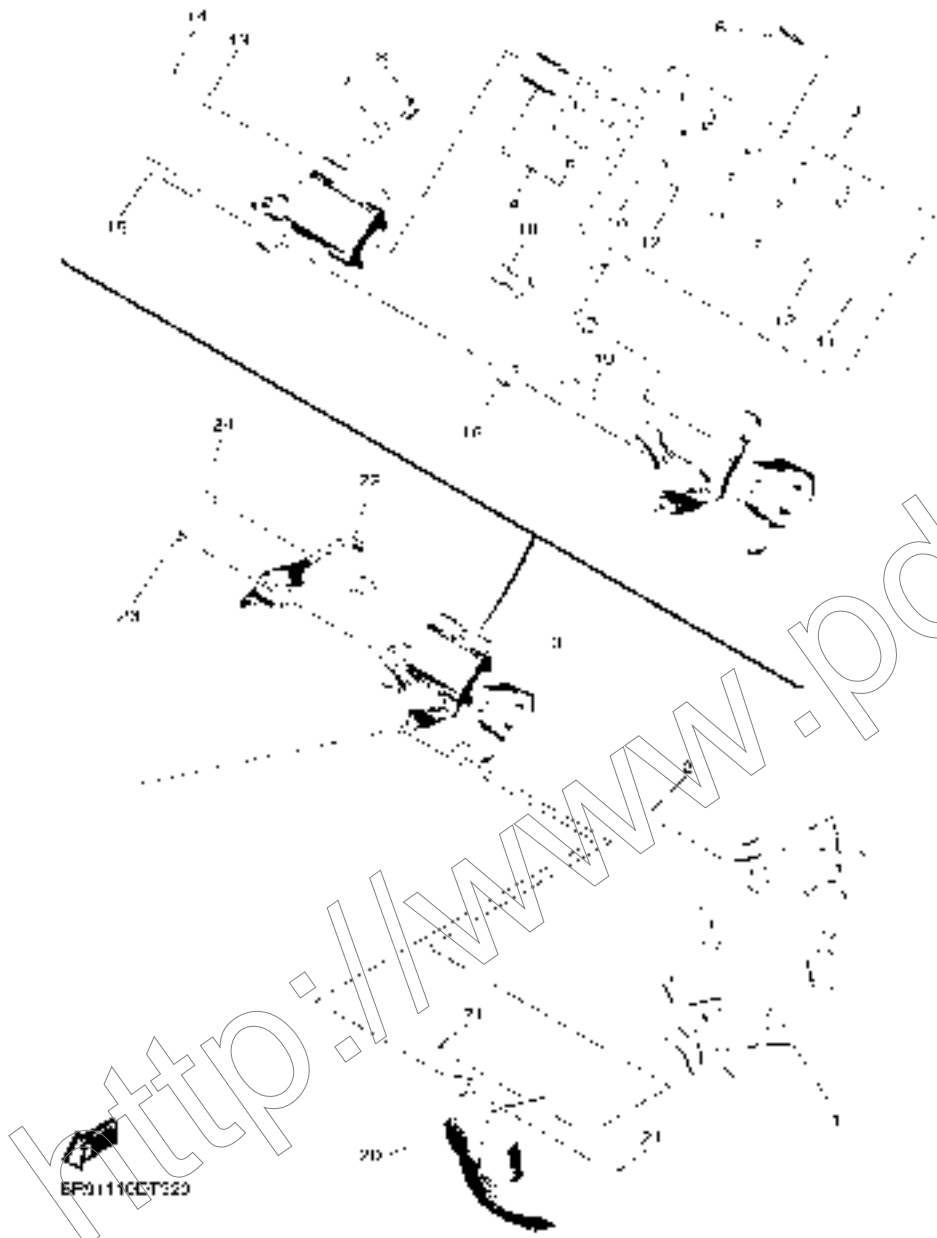

FIG. 33 STEERING HANDLE & CABLE

REF. NO.	PART NO.	DESCRIPTION	QTY	REMARKS
1	BR9-26111-00	HANDLEBAR	1	
2	4GY-26241-00	GRIP	1	
3	1SL-26240-00	GRIP ASSY	1	
4	4GY-26242-00	.GRIP (RIGHT)	1	
5	3Y1-26249-00	.RING, LEAF	1	
6	5BE-26281-01	CAP, GRIP UPPER	1	
7	5BE-26282-00	CAP, GRIP UNDER	1	
8	98507-05020	SCREW, PAN HEAD	2	
9	5SF-26287-11	COVER, CAP GRIP	1	
10	BR9-26302-00	THROTTLE CABLE ASSY	1	
11	BR9-26335-00	CABLE, CLUTCH	1	
12	34P-26342-00	BOOT, CABLE	1	
13	17D-26124-00	PROTECTOR, HANDLEBAR	1	
14	17D-26143-H0	COVER, HANDLE UPPER 1	1	

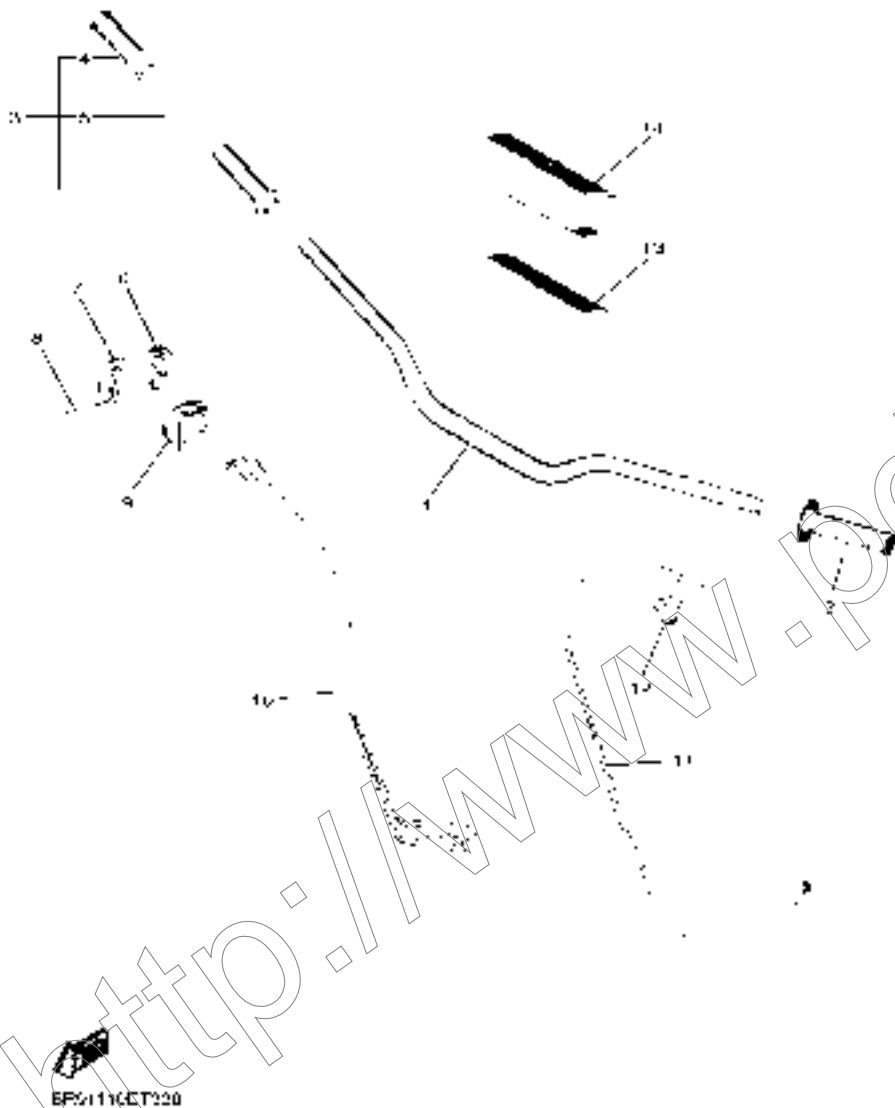

FIG. 34 FRONT MASTER CYLINDER

REF. NO.	PART NO.	DESCRIPTION	QTY	REMARKS
1	1SL-25872-00	HOSE, BRAKE 1	1	
2	90430-10005	GASKET	4	
3	90401-10172	BOLT, UNION	2	
4	5XC-W2587-00	MASTER CYLINDER SUB ASSY	1	
5	5XC-W0041-00	.CYLINDER KIT, MASTER	1	
6	5XC-25854-G0	.DIAPHRAGM, RESERVOIR	1	
7	5XC-25852-G0	.CAP, RESERVOIR	1	
8	98706-04012	.SCREW, FLAT HEAD	2	
9	5CG-25715-00	.SEPARATOR ASSY	1	
10	5CG-2585G-00	.CIRCLIP	1	
11	5XC-25853-G0	.FLOAT, RESERVOIR	1	
12	5XC-83922-L0	LEVER 2	1	
13	5MV-2589F-00	BOLT, LEVER	1	
14	95701-06500	NUT, WITH WASHER	1	
15	5MV-25867-00	BRACKET, MASTER CYLINDER	1	
16	5MV-25833-00	BOLT, FITTING	2	
17	5XC-26372-G0	COVER, HANDLE LEVER 1	1	



FIG. 35 STAND & FOOTREST

REF. NO.	PART NO.	DESCRIPTION	BR96				REMARKS
1	33D-27200-01	PEDAL, BRAKE	1				
2	17D-27217-00	BOLT	1				
3	93210-11073	O-RING	2				
4	90468-16001	CLIP	1				
5	90506-18019	SPRING, TENSION	1				
6	90240-08120	PIN, CLEVIS	1				
7	90201-08044	WASHER, PLATE	1				
8	91402-20012	PIN, COTTER	1				
9	5XC-27411-M2	FOOTREST 1	1				
10	5XC-27421-M2	FOOTREST 2	1				
11	90508-28015	SPRING, TORSION	1				
12	90508-28018	SPRING, TORSION	1				
13	90240-10004	PIN, CLEVIS	2				
14	90201-10032	WASHER, PLATE	2				
15	91402-25015	PIN, COTTER	2				
16	34P-27311-00	STAND, SIDE	1				

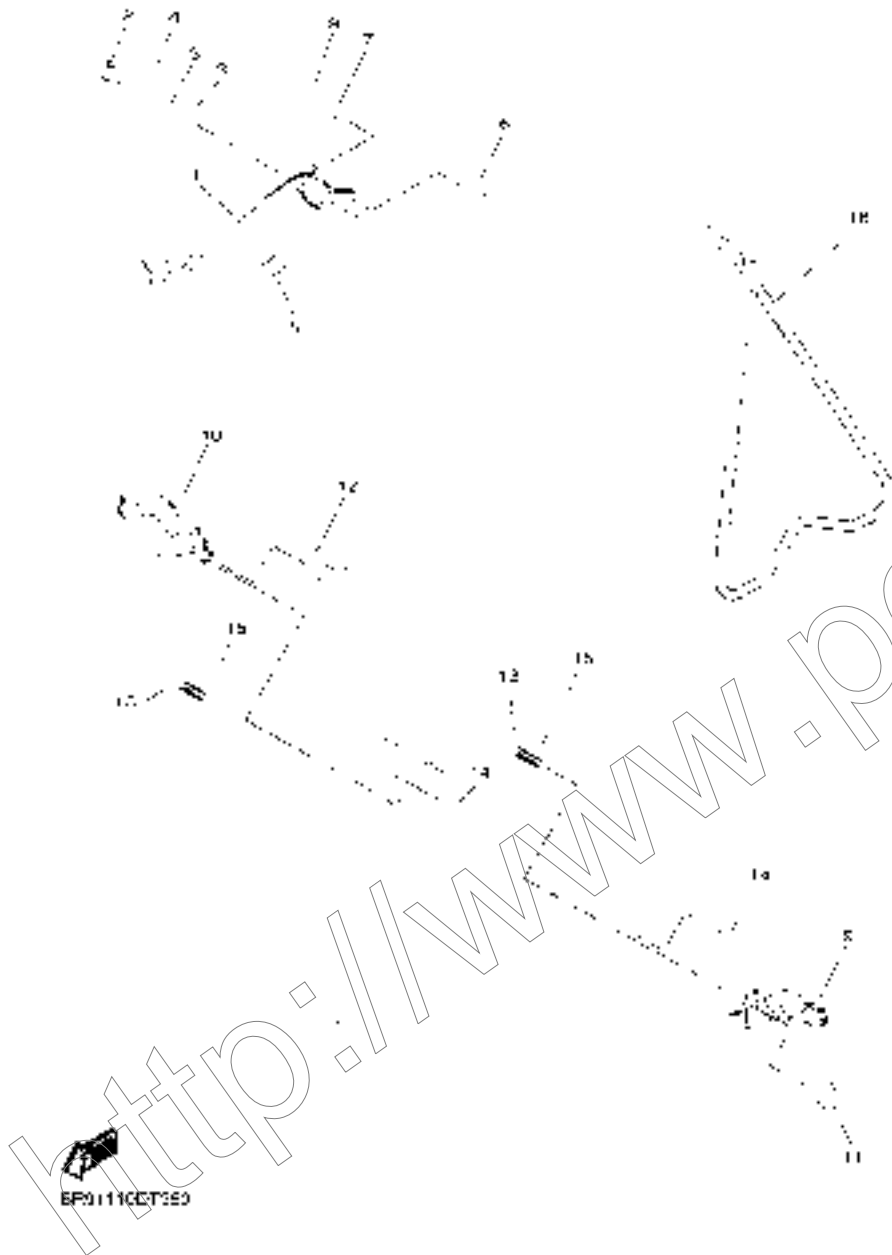
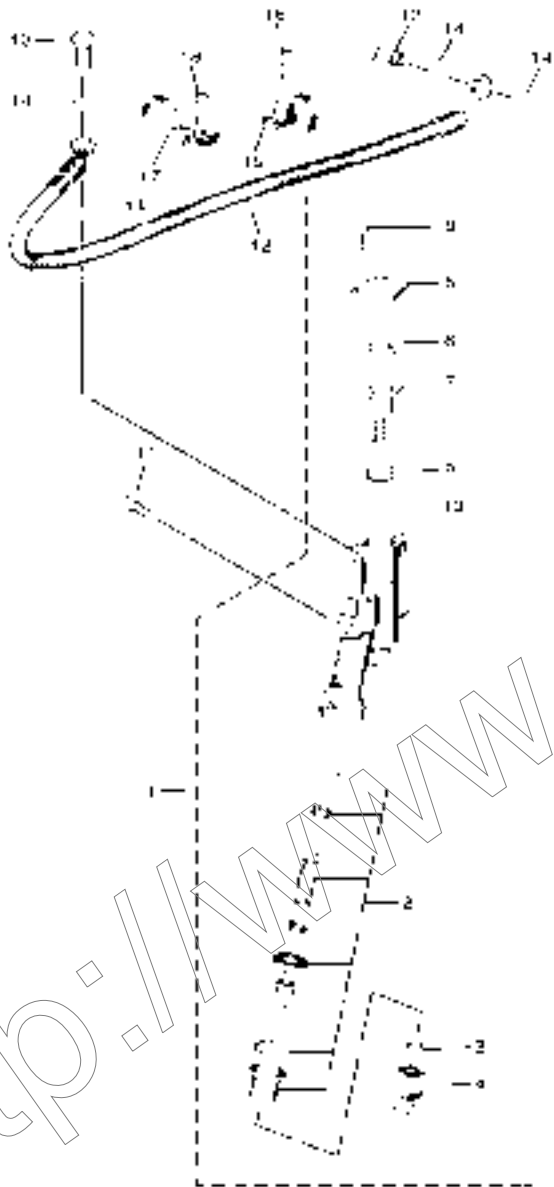

FIG. 36 REAR MASTER CYLINDER



REF. NO.	PART NO.	DESCRIPTION	BR96	REMARKS
1	33D-2583V-00	RR. MASTER CYLINDER ASSY.	1	
2	5UN-W0042-50	.CYLINDER KIT, MASTER	1	
3	5UN-27218-00	.NUT	1	
4	5UN-27222-00	.JOINT	1	
5	5UN-25852-50	.CAP, RESERVOIR	1	
6	5UN-2585B-00	.PLATE, DIAPHRAGM	1	
7	5UN-25854-00	.DIAPHRAGM, RESERVOIR	1	
8	5UN-27217-00	.BOLT	2	
9	5CG-25715-00	.SEPARATOR ASSY	1	
10	5CG-2585G-00	.CIRCLIP	1	
11	90111-06116	BOLT,HEX. SOCKET BUTTON	2	
12	5XC-25873-L0	HOSE, BRAKE 2	1	
13	90401-10172	BOLT, UNION	2	
14	90430-10005	GASKET	4	
15	1C3-25886-50	HOLDER, BRAKE HOSE	1	
16	98502-05010	SCREW, PAN HEAD	2	
17	1C3-25876-50	HOLDER, BRAKE HOSE 2	1	
18	98502-05010	SCREW, PAN HEAD	2	

FIG. 37 GENERATOR

REF. NO.	PART NO.	DESCRIPTION	BR96	REMARKS
1	BR9-81410-00	STATOR ASSY	1	
2	BR9-81450-00	ROTOR ASSY	1	
3	90179-12657	NUT	1	
4	90201-127E1	WASHER, PLATE	1	
5	90149-05040	SCREW	3	
6	90110-06401	BOLT, HEXAGON SOCKET HEAD	2	
7	BR9-81528-00	CLAMP 1	1	
8	90110-05003	BOLT, HEXAGON SOCKET HEAD	1	

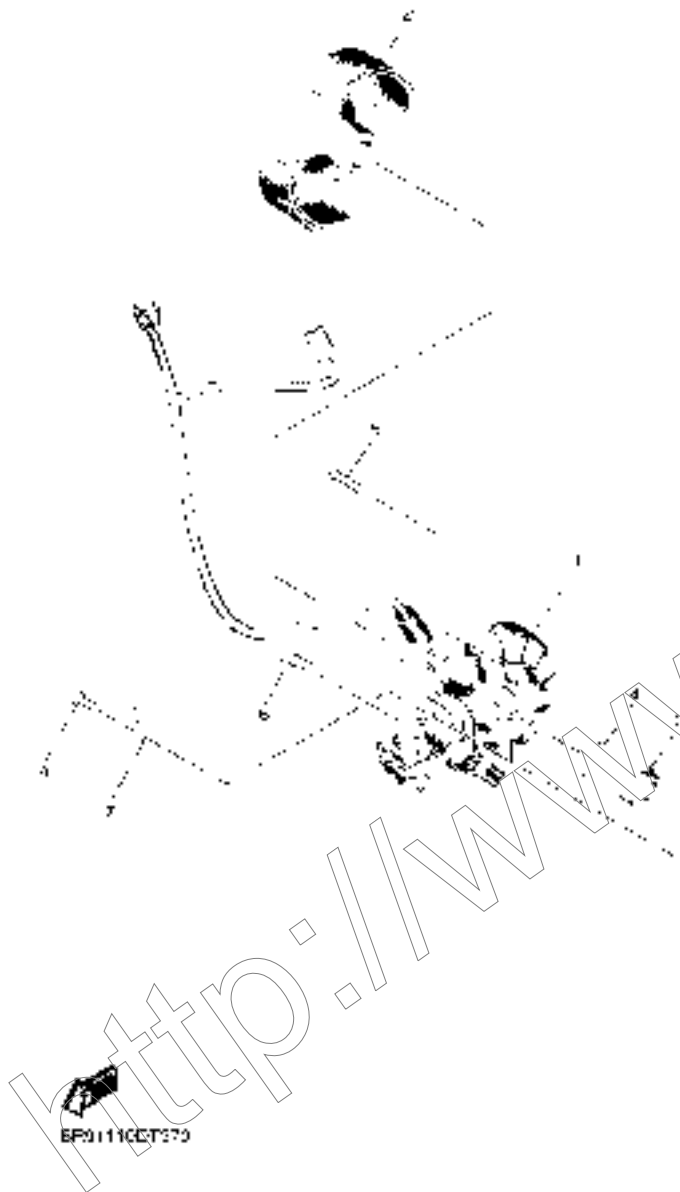

EP91110CT379

FIG. 38 STARTING MOTOR

REF. NO.	PART NO.	DESCRIPTION	BR96	REMARKS
1	90465-10098	CLAMP	1	
2	BR9-81890-00	MOTOR ASSY	1	
3	2CR-81801-00	.BRUSH SET	1	
4	4FP-H182L-00	.O-RING 1	1	
5	BR9-81846-00	.SCREW	2	
6	BR9-8182L-00	.O-RING 1	1	
7	BR9-81861-00	.GASKET	2	
8	2CR-81828-10	.BOLT 2	1	
9	8FA-8181L-00	.WASHER, PLAIN	1	
10	1D7-81835-00	.WASHER	1	
11	95302-06700	.NUT, HEXAGON	1	
12	BR9-8183G-00	CORD COMP.	1	
13	95302-06700	NUT, HEXAGON	1	
14	90110-06349	BOLT, HEXAGON SOCKET HEAD	2	

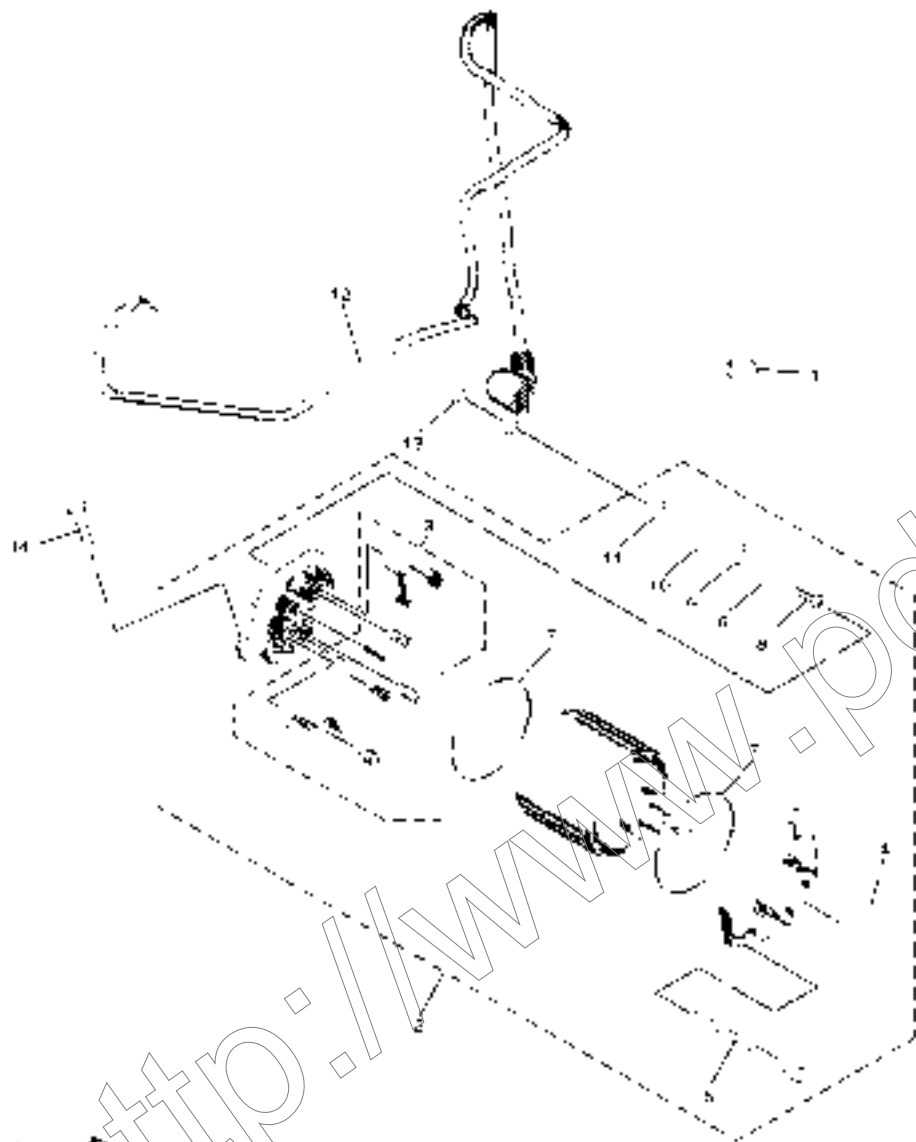

FIG. 39 HANDLE SWITCH & LEVER

REF. NO.	PART NO.	DESCRIPTION	QTY	REMARKS
1	17D-82911-00	HOLDER, LEVER 1	1	
2	17D-83912-01	LEVER 1	1	
3	90109-06034	BOLT	1	
4	5LP-84126-10	NUT, LENS FITTING	1	
5	17D-26337-00	BOLT, ADJUSTING	1	
6	95302-05600	NUT, HEXAGON	1	
7	90101-05005	BOLT	1	
8	34P-26372-00	COVER, HANDLE LEVER 1	1	
9	33D-82913-00	HOLDER, LEVER LOWER 1	1	
10	95022-06020	BOLT, FLANGE	2	
11	2GB-83976-00	SWITCH, HANDLE 1	1	
12	B11-83976-00	SWITCH, HANDLE 1	1	
13	1SL-83976-00	SWITCH, HANDLE 1	1	



FIG. 40 ELECTRICAL 1

REF. NO.	PART NO.	DESCRIPTION	BR96	REMARKS
1	33D-82370-00	PLUG CAP ASSY	1	
2	4P9-83591-00	THERMO UNIT	1	
3	90430-10004	GASKET	1	
4	B11-82540-00	NEUTRAL SWITCH ASSY	1	
5	90110-05062	BOLT, HEXAGON SOCKET HEAD	2	
6	93210-21001	O-RING	1	
7	BR9-8591A-10	ENGINE CONTROL UNIT ASSY	1	
8	90105-05005	BOLT, FLANGE	2	
9	90387-05048	COLLAR	2	
10	90480-13029	GROMMET	2	
11	BR9-82310-00	IGNITION COIL ASSY	1	
12	BR9-8231U-00	CORE, SIDE	1	
13	90480-11015	GROMMET	1	
14	95022-06016	BOLT, FLANGE	2	
15	BR9-85810-00	COMMUNICATION CONT. UNIT ASSY	1	
16	BR9-85721-00	WIRE, LEAD	1	
17	BR9-85546-00	BAND	1	

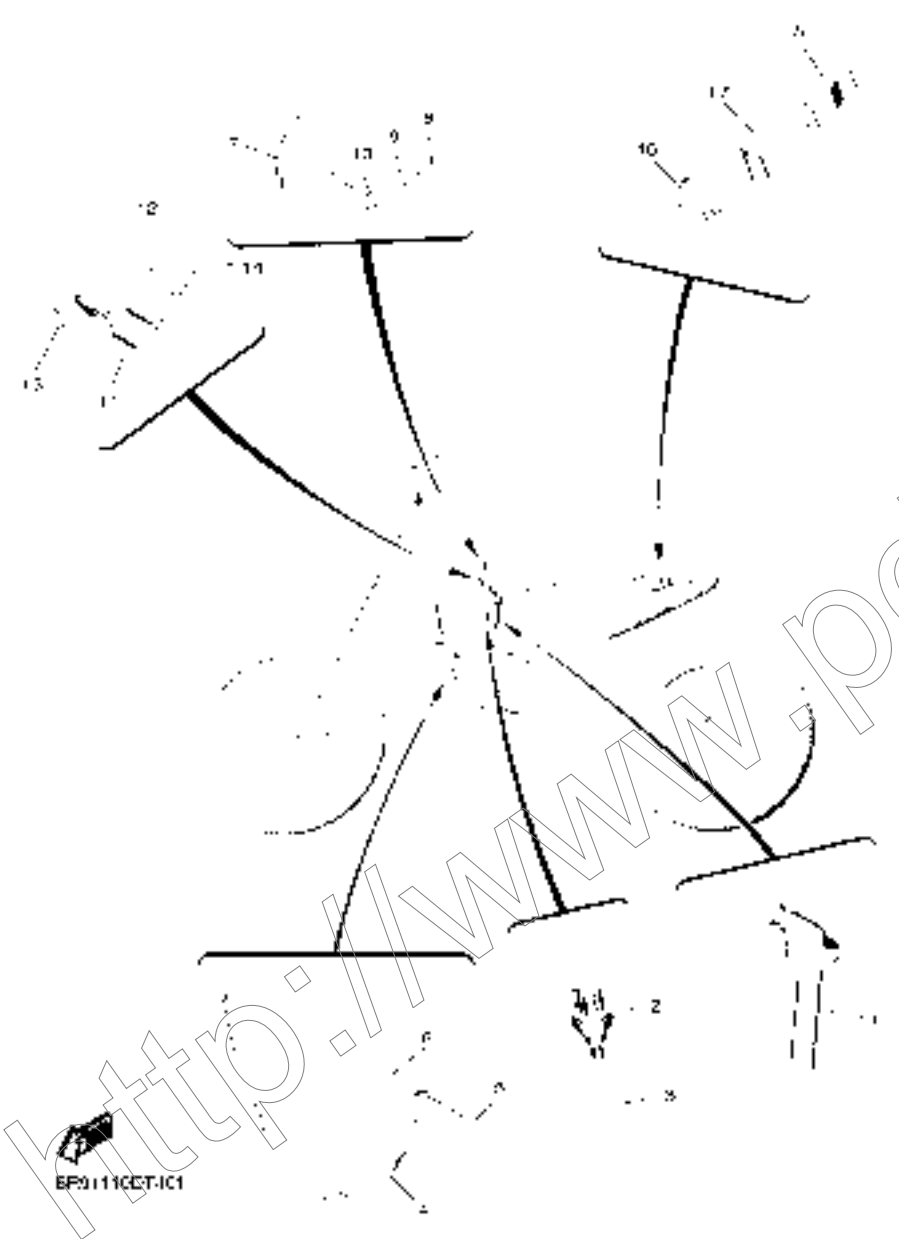

EP9111CCT-IC1

FIG. 41 ELECTRICAL 2

REF. NO.	PART NO.	DESCRIPTION	BR96	REMARKS
1	1SL-81960-00	RECTIFIER & REGULATOR ASSY	1	
2	BR9-21287-00	BRACKET, REGULATOR	1	
3	90105-06219	BOLT, FLANGE	2	
4	90480-13025	GROMMET	2	
5	90387-066J9	COLLAR	2	
6	90105-06064	BOLT, FLANGE	2	
7	BR9-82590-00	WIRE HARNESS ASSY	1	
8	4WA-81980-00	.DIODE ASSY	1	
9	3WP-81980-00	.DIODE ASSY	2	
10	1SL-82309-00	WIRE, SUB LEAD	1	
11	33D-82378-00	CONNECTOR	1	
12	BR9-82388-00	PLATE	1	
13	90105-06110	BOLT, FLANGE	1	
14	95022-06010	BOLT, FLANGE	1	
15	90464-17003	CLAMP	1	
16	90464-13077	CLAMP	2	(95.0X7.0)
17	90464-13073	CLAMP	2	(125.0x7.0)
18	1UA-82591-00	BAND	1	
19	BR9-82100-19	BATTERY ASSY (BR98)	1	
20	BR9-82128-00	BRACKET, BATTERY	1	
21	90119-06133	BOLT, WITH WASHER	4	
22	BR9-82176-00	DAMPER	1	
23	8CY-82131-00	BAND, BATTERY	1	
24	BR9-82115-00	WIRE, PLUS LEAD	1	
25	BR9-82116-00	WIRE, MINUS LEAD	1	
26	90105-06064	BOLT, FLANGE	1	
27	2GB-81940-00	STARTER RELAY ASSY (RC19-102B)	1	

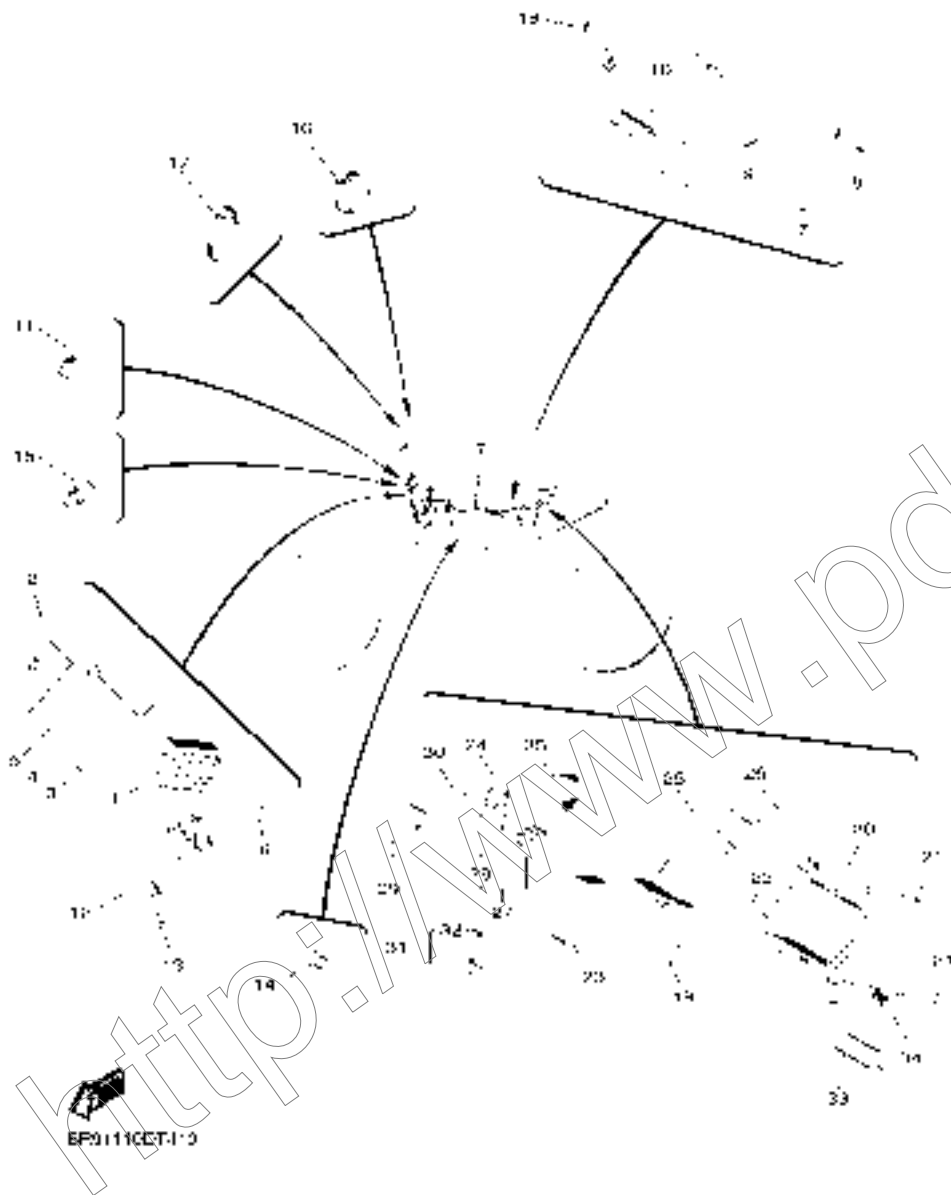
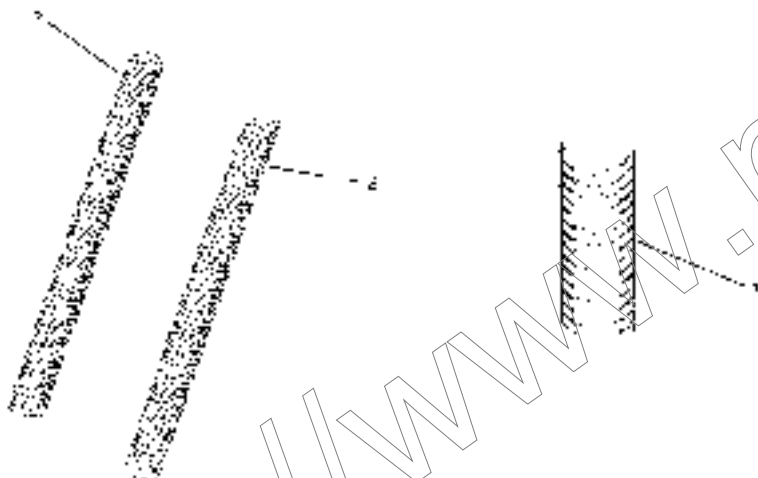

FIG. 42 ALTERNATE FOR CHASSIS

REF. NO.	PART NO.	DESCRIPTION	BR96	REMARKS
1	BR9-22212-00	SPRING (K=52 BLUE)	1	AP
	BR9-22212-10	SPRING (K=54 BLUE)	1	AP
	BR9-22212-30	SPRING (K=58 BLUE)	1	AP
	BR9-22212-40	SPRING (K=60 BLUE)	1	AP
2	BR9-23141-20	SPRING, FRONT FORK (K=4.5)	1	AP
	BR9-23141-30	SPRING, FRONT FORK (K=4.6)	1	AP
	BR9-23141-40	SPRING, FRONT FORK (K=4.7)	1	AP
	BR9-23141-50	SPRING, FRONT FORK (K=4.8)	1	AP
	BR9-23141-60	SPRING, FRONT FORK (K=4.9)	1	AP
	BR9-23141-70	SPRING, FRONT FORK (K=5.0)	1	AP
	BR9-23141-80	SPRING, FRONT FORK (K=5.1)	1	AP



EP211CCT-120

NUMERICAL INDEX

PART NO.	REF. NO.	PART NO.	REF. NO.	PART NO.	REF. NO.	PART NO.	REF. NO.	PART NO.	REF. NO.	PART NO.	REF. NO.
BR9-11102-00	1 - 1	3LD-12168-K1	3 - 13	8FP-13556-00	10 - 2	1SM-14788-00	12 - 9	BR9-18110-00	19 - 14	5BE-21749-00	21 - 6
5PS-11133-10	1 - 2	3LD-12168-M1	3 - 13	BR9-13597-00	9 - 1	1SL-14798-10	12 - 24	1SL-18122-10	19 - 3		22 - 9
5PS-11134-10	1 - 3	3LD-12168-R1	3 - 13	BR9-13750-00	10 - 1	BR9-15100-09	13 - 5	2GB-18140-10	18 - 12		22 - 18
BR9-11166-00	11 - 1	3LD-12168-U1	3 - 13	3B4-13761-00	10 - 11	5XC-15118-00	13 - 29	1SL-18172-00	19 - 8		22 - 26
341-11167-00	1 - 23	3LD-12168-W1	3 - 13	33D-13907-01	27 - 15	BR9-15155-00	13 - 7	3XJ-18173-10	19 - 2	5TA-21749-00	22 - 3
BR9-11181-00	1 - 14	3LD-12168-Y1	3 - 13	BR9-13971-00	27 - 19	3Y1-15361-00	13 - 28	33D-18175-00	18 - 15		22 - 10
BR9-11190-10	1 - 21	3LD-12169-11	3 - 13	BR9-1410A-00	10 - 10	3Y1-15363-10	14 - 8	3XJ-18178-00	19 - 4	5TJ-21757-00	9 - 33
33D-11193-01	1 - 25	3LD-12169-31	3 - 13	5PS-14147-00	10 - 12	1SL-15378-00	13 - 20	3XJ-18182-00	19 - 5	5FK-2175C-30	21 - 12
33D-11195-00	1 - 27	3LD-12169-50	3 - 13	363-14198-00	10 - 6	BR9-15378-00	15 - 4	3XJ-18184-00	19 - 7	4XV-2177L-01	9 - 18
5UM-1119E-00	1 - 26	3LD-12169-70	3 - 13	2C0-14216-00	10 - 3	4JT-15381-01	13 - 23	2GB-18185-00	19 - 1	BR9-217R0-A0	22 - 16
BR9-11311-00	1 - 28	3LD-12169-90	3 - 13	8CC-14216-10	10 - 7	18P-15383-00	13 - 21	1SL-18511-00	18 - 6	BR9-217S0-A0	22 - 24
BR9-11351-00	1 - 29	3LD-12169-E0	3 - 13	BR9-14293-00	9 - 4	BR9-15388-00	13 - 25	1SL-18512-00	18 - 7	BR9-22110-00	23 - 1
BR9-11395-00	1 - 32	3LD-12169-G0	3 - 13	BR9-14348-00	10 - 4	BR9-15411-00	14 - 3	1SL-18513-00	18 - 8	5XC-22121-91	23 - 28
BR9-11400-00	2 - 1	3LD-12169-J0	3 - 13	8GC-14406-00	9 - 10	33D-15415-20	14 - 23	1SL-18531-00	18 - 9	34P-22122-00	23 - 29
BR9-11412-00	2 - 2	3LD-12169-L0	3 - 13	BR9-14411-01	9 - 7	1SL-15421-00	13 - 17	1SL-18535-00	18 - 10	2S2-22128-70	23 - 11
BR9-11422-00	2 - 3	3LD-12169-N0	3 - 13	BR9-14412-00	9 - 28	BR9-15431-00	14 - 16	BR9-18541-10	18 - 1	33D-22141-00	23 - 15
33D-11454-00	2 - 14	3LD-12169-T0	3 - 13	BR9-14422-00	9 - 19	BR9-15436-00	14 - 1	3D7-18542-00	18 - 2	34P-22151-01	23 - 8
BR9-11455-00	2 - 9	BR9-12170-00	4 - 1	BR9-14449-00	9 - 23	BR9-15441-00	13 - 15	1SL-18562-00	13 - 26	5UN-22176-00	24 - 14
33D-11464-00	2 - 16	BR9-12180-00	4 - 2	BR9-14451-00	9 - 14	BR9-15451-00	14 - 10	BR9-21101-10	20 - 1	30X-22178-00	20 - 7
2S2-11531-10	2 - 11	5TA-12210-30	4 - 9	1SL-14452-00	9 - 29	33D-15453-00	14 - 24	BR9-21149-00	20 - 18	BR9-22178-00	20 - 12
2S2-11536-00	2 - 8	4FM-12213-00	4 - 12	BR9-14453-00	9 - 8	BR9-15462-00	14 - 20	B29-21163-00	20 - 37	17D-2217A-00	23 - 18
33D-11603-00	2 - 22	5EL-12214-00	4 - 11	BR9-14457-00	9 - 30	BR9-15560-00	15 - 1	1SL-21163-01	20 - 35	BR9-2217F-00	23 - 24
BR9-11631-00	2 - 21	5EL-12228-00	4 - 10	BR9-14458-00	9 - 15	BR9-15570-10	15 - 3	BR9-21190-00	20 - 5	4V4-22184-00	20 - 8
BR9-11633-00	2 - 23	1SL-12233-00	4 - 7	BR9-14459-00	9 - 9	2S2-16111-60	16 - 1	BR9-21287-00	41 - 2	5MV-22184-00	24 - 15
33D-11651-03	2 - 6	5BE-12241-00	1 - 24	20S-1445C-00	9 - 27	BR9-16150-00	16 - 4	BR9-21417-00	20 - 23	2S2-22199-70	23 - 10
5TG-11681-01	2 - 4	BR9-12251-00	4 - 5	BR9-14462-00	9 - 21	5XD-16154-00	16 - 11	BR9-21425-00	20 - 29	BR9-22200-80	24 - 1
BR9-116A0-00	2 - 20	33D-12252-00	4 - 6	BR9-14467-00	22 - 22	5TA-16321-00	16 - 8	BR9-21426-00	20 - 30	BR9-22201-50	24 - 2
1SL-11917-00	5 - 6	BR9-1240A-00	6 - 7		22 - 30	5VY-16321-00	16 - 12	17D-21447-00	20 - 2	BR9-22212-00	42 - 1
1SL-12111-00	3 - 1	33D-12422-00	5 - 8	BR9-1446R-00	22 - 23	BR9-16324-00	16 - 7	17D-21448-00	20 - 3	BR9-22212-10	42 - 1
BR9-12113-00	3 - 6	33D-12427-00	5 - 9		22 - 31	BR9-16351-00	16 - 6	BR9-21471-00	20 - 32	BR9-22212-20	24 - 8
BR9-12114-00	3 - 7	1SL-12446-00	6 - 4	BR9-14486-00	10 - 5	BR9-16356-00	16 - 15	BR9-21511-00	21 - 1	BR9-22212-30	42 - 1
33D-12116-00	3 - 4	BR9-12450-00	5 - 1	5VX-14503-00	10 - 9	1SL-16357-10	16 - 19	BR9-21610-00	21 - 4	BR9-22212-40	42 - 1
33D-12117-00	3 - 8	BR9-12461-00	6 - 8	BR9-14611-00	12 - 1	5TA-16371-20	16 - 5	5XE-21635-10	21 - 5	1SL-22213-00	24 - 6
3LD-12117-00	3 - 9	5SL-12462-00	6 - 9	33D-14613-00	12 - 5	BR9-16381-00	13 - 31	3D7-21642-00	21 - 10	33D-22214-00	24 - 9
3LD-12118-00	3 - 10	33D-12465-00	6 - 10	BR9-14621-00	12 - 7	BR9-17121-00	17 - 9	BR9-21710-00	22 - 1	33D-22224-00	24 - 10
51Y-12119-00	3 - 3	BR9-12482-00	6 - 1	1SL-14628-00	12 - 2	BR9-17131-00	17 - 6	1SL-21719-00	22 - 13	4JX-22226-00	24 - 3
1SL-12121-00	3 - 2	5BE-12564-00	5 - 14	BR9-14639-00	12 - 11	BR9-17141-00	17 - 7	BR9-21719-00	22 - 11	33D-22234-00	24 - 5
33D-12126-00	3 - 5	BR9-12576-00	6 - 13	BR9-1466G-00	12 - 18	BR9-17151-00	17 - 3	BR9-2171X-01	20 - 40	5NY-22241-00	24 - 21
BR9-12153-00	3 - 11	BR9-12577-00	6 - 14	1SL-1469A-10	12 - 19	2S2-17211-00	17 - 14	BR9-21720-01	22 - 7	5XE-22242-01	24 - 18
5EB-12153-10	3 - 12	BR9-12578-00	6 - 15	1SL-1469F-00	12 - 21	BR9-17221-00	17 - 25	BR9-2172A-00	22 - 34	1C3-22253-50	24 - 11
3LD-12168-00	3 - 13	BR9-12579-00	6 - 16	1SL-14714-00	12 - 25	BR9-17231-00	17 - 20	BR9-2172F-00	22 - 35	1C3-22253-L1	24 - 16
3LD-12168-20	3 - 13	BR9-13160-00	10 - 8	BR9-14715-00	12 - 28	BR9-17241-00	17 - 23	BR9-21730-80	22 - 16	4AA-22259-40	24 - 7
3LD-12168-40	3 - 13	1SL-13300-00	7 - 1	5VY-14747-00	12 - 12	BR9-17251-00	17 - 17	BR9-21740-80	22 - 24	4EW-22474-00	24 - 13
3LD-12168-60	3 - 13	BR9-13371-00	13 - 1	BR9-14750-10	12 - 15	BR9-17402-00	17 - 13	1DX-21746-01	22 - 12	3JE-22475-00	24 - 12
3LD-12168-80	3 - 13	1SL-13411-10	7 - 4	5PX-14755-00	12 - 8	BR9-17411-00	17 - 2	1SL-21748-00	22 - 19	5NY-22475-00	24 - 17
3LD-12168-A0	3 - 13	5D3-13440-02	8 - 1	1SL-1477E-00	12 - 20	1SL-17466-00	13 - 18		22 - 27	5UN-22898-60	32 - 12
3LD-12168-F0	3 - 13	1SL-13447-00	8 - 2	1SL-1477G-00	12 - 22	1SL-17471-00	17 - 34	17D-21749-00	22 - 17	1C3-22969-90	23 - 9
3LD-12168-H1	3 - 13	1SL-13475-00	13 - 2	1SL-1477H-00	12 - 23	1SL-18101-00	19 - 10		22 - 25	BR9-23102-30	26 - 1

NUMERICAL INDEX

PART NO.	REF. NO.	PART NO.	REF. NO.	PART NO.	REF. NO.	PART NO.	REF. NO.	PART NO.	REF. NO.	PART NO.	REF. NO.
BR9-23103-30	26 - 24	1C3-23188-L0	26 - 38	4XM-25364-00	31 - 16	3SP-25914-51	30 - 13	2CR-81828-10	38 - 8	5XC-W0041-00	34 - 5
BR9-23110-00	26 - 27	1C3-23188-P0	26 - 16	17D-25381-00	31 - 23	5DH-25916-00	30 - 11	BR9-8182L-00	38 - 6	5UN-W0042-50	36 - 2
5XC-23111-00	26 - 21		26 - 39	1SL-25388-00	31 - 19		32 - 14	1D7-81835-00	38 - 10	1C3-W0046-B0	32 - 9
	26 - 44	1C3-23188-R0	26 - 19	1SL-25389-00	31 - 20	3JD-25917-00	30 - 14	BR9-8183G-00	38 - 12	5UN-W0047-50	32 - 5
276-23114-00	26 - 23		26 - 42	3JE-25394-00	31 - 15		32 - 16	BR9-81846-00	38 - 5	5UN-W0057-50	32 - 4
	26 - 46	1C3-23190-L0	26 - 18	5SF-25394-00	29 - 10	5DH-25919-00	30 - 6	BR9-81861-00	38 - 7	5XC-W2587-00	34 - 4
BR9-23120-00	26 - 4		26 - 41	17D-25447-50	31 - 6	5DH-25919-50	32 - 6	BR9-81890-00	38 - 2	90101-05005	39 - 7
5XE-23125-L0	26 - 6	33D-23340-20	26 - 47	17D-25448-50	31 - 6	8CR-25924-00	32 - 13	2GB-81940-00	41 - 27	90101-06041	19 - 9
	26 - 29	17D-23389-50	25 - 2	17D-25449-50	31 - 6	3SP-25926-51	30 - 12	1ST-81950-00	41 - 31	90101-08006	31 - 21
33D-23136-00	26 - 2	17D-23416-50	25 - 6	17D-25450-50	31 - 6	5DH-25933-00	30 - 10	5JJ-81952-00	41 - 32	90105-05005	40 - 8
	26 - 25	1SL-23434-00	25 - 13	17D-25451-50	31 - 6	1UY-25937-51	30 - 15	1SL-81960-00	41 - 1	90105-06027	1 - 4
BR9-23141-00	26 - 20	1SL-23435-10	25 - 9	17D-25452-50	31 - 6		32 - 18	1DX-81965-10	41 - 33	90105-06064	22 - 32
	26 - 43	18P-23441-00	25 - 11	5CG-25715-00	34 - 9	BR9-26111-00	33 - 1	3WP-81980-00	41 - 9		25 - 18
BR9-23141-20	42 - 2	BR9-23442-00	25 - 12		36 - 9	17D-26124-00	33 - 13	4WA-81980-00	41 - 8		27 - 11
BR9-23141-30	42 - 2	17D-23466-00	26 - 52	17D-25718-50	32 - 20	17D-26143-H0	33 - 14	BR9-82100-19	41 - 19		41 - 6
BR9-23141-40	42 - 2	17D-23467-00	26 - 53	5XC-25802-00	30 - 4	1SL-26240-00	33 - 3	BR9-82115-00	41 - 24		41 - 26
BR9-23141-50	42 - 2	BR9-23485-00	25 - 17	5KM-25803-10	30 - 5	4GY-26241-00	33 - 2	BR9-82116-00	41 - 25	90105-06081	17 - 35
BR9-23141-60	42 - 2	BR9-24110-00	27 - 1	B29-25805-00	30 - 9	4GY-26242-00	33 - 4	5SL-82119-10	41 - 29	90105-06099	13 - 16
BR9-23141-70	42 - 2	BR9-24114-00	27 - 4	B11-2580T-00	30 - 3	3Y1-26249-00	33 - 5	BR9-82128-00	41 - 20	90105-06100	21 - 8
BR9-23141-80	42 - 2	4EW-2412F-00	27 - 21	17D-2580W-11	32 - 3	5BE-26281-01	33 - 6	8CY-82131-00	41 - 23	90105-06104	23 - 12
BR9-23142-01	26 - 13	33D-24135-00	27 - 20	B11-2581T-00	30 - 1	5BE-26282-00	33 - 7	36Y-82151-00	41 - 28	90105-06105	23 - 14
	26 - 36	2D1-2414R-00	27 - 2	1UY-25824-51	30 - 7	5SF-26287-11	33 - 9	BR9-82176-00	41 - 22	90105-06110	32 - 21
5XE-23144-L0	26 - 10	BR9-24181-00	20 - 42		32 - 7	BR9-26302-00	33 - 10	1SL-82309-00	41 - 10		32 - 23
	26 - 33	BR9-24182-00	20 - 43	1UY-25825-51	30 - 8	BR9-26335-00	33 - 11	BR9-82310-00	40 - 11		41 - 13
B29-23145-00	26 - 8	BR9-24183-00	20 - 44		32 - 8	17D-26337-00	39 - 5	BR9-8231U-00	40 - 12	90105-06111	32 - 24
	26 - 31	BR9-24188-01	27 - 3	5UN-25827-60	32 - 11	34P-26342-00	33 - 12	33D-82370-00	40 - 1	90105-06148	4 - 13
5XC-23146-10	26 - 7	BR9-24191-00	27 - 7	5UN-25828-60	32 - 10	34P-26372-00	39 - 8	33D-82378-00	41 - 11	90105-06170	20 - 34
	26 - 30	BR9-2419A-00	27 - 10	B11-2582W-10	32 - 1	5XC-26372-G0	34 - 17	2C0-82380-00	10 - 14		25 - 3
1AE-23147-00	26 - 17	33D-24486-00	27 - 16	5MV-25833-00	34 - 16	33D-27200-01	35 - 1	BR9-82388-00	41 - 12		26 - 54
	26 - 40	BR9-24491-00	27 - 17	33D-2583V-00	36 - 1	17D-27217-00	35 - 2	B11-82540-00	40 - 4	90105-06189	13 - 19
1C3-23147-L0	26 - 12	BR9-24610-00	27 - 5	5XC-25849-G0	30 - 16	5UN-27217-00	36 - 8	BR9-82590-00	41 - 7	90105-06203	9 - 34
	26 - 35	BR9-2464E-00	28 - 3	5UN-25852-50	36 - 5	5UN-27218-00	36 - 3	1UA-82591-00	41 - 18		13 - 3
17D-23153-00	26 - 3	18P-2464V-00	20 - 48	5XC-25852-G0	34 - 7	5UN-27222-00	36 - 4	17D-82911-00	39 - 1		27 - 8
	26 - 26	18P-2467E-00	20 - 47	5XC-25853-G0	34 - 11	34P-27311-00	35 - 16	33D-82913-00	39 - 9	90105-06219	41 - 3
5XE-23153-L0	26 - 9	BR9-2470F-00	28 - 2	5UN-25854-00	36 - 7	5XC-27411-M2	35 - 9	4P9-83591-00	40 - 2	90105-08137	30 - 17
	26 - 32	BR9-24710-A0	28 - 1	5XC-25854-G0	34 - 6	5XC-27421-M2	35 - 10	17D-83912-01	39 - 2	90105-08143	20 - 24
2HH-23158-L0	26 - 22	1SL-24734-00	28 - 5	5UN-2585B-00	36 - 6	17D-27491-50	32 - 22	5XC-83922-L0	34 - 12		20 - 31
	26 - 45	1SL-24742-00	28 - 4	5CG-2585G-00	34 - 10	5ET-28166-10	20 - 45	1SL-83976-00	39 - 13	90105-08154	25 - 16
17D-2315H-50	26 - 50	5NY-25104-00	29 - 6		36 - 10	5PG-2816R-00	21 - 13	2GB-83976-00	39 - 11		26 - 48
17D-2315J-50	26 - 49	1SL-25111-00	29 - 1	5MV-25867-00	34 - 15	BR9-28199-81	20 - 46	B11-83976-00	39 - 12	90105-08230	20 - 6
BR9-2316A-30	26 - 14	1SL-25117-00	29 - 3	1SL-25872-00	34 - 1	1SL-28386-00	9 - 32	5LP-84126-10	39 - 4		22 - 4
	26 - 37	1SL-25181-00	29 - 11	5XC-25873-L0	36 - 12	BR9-81128-00	1 - 20	BR9-85546-00	40 - 17		22 - 14
BR9-23170-30	26 - 11	BR9-25183-00	29 - 12	1C3-25876-50	36 - 17	BR9-81410-00	37 - 1	BR9-85721-00	40 - 16	90105-08232	20 - 15
	26 - 34	1SL-25186-00	29 - 13	1C3-25886-50	36 - 15	BR9-81450-00	37 - 2	BR9-85810-00	40 - 15	90105-10163	1 - 17
5XE-23171-L0	26 - 5	34P-25304-00	31 - 10	5MV-2589F-00	34 - 13	BR9-81528-00	37 - 7	BR9-85885-00	10 - 13	90105-10176	20 - 25
	26 - 28	BR9-2530S-00	31 - 18	5UN-25913-00	32 - 19	BR9-81627-00	41 - 34	5YU-85886-00	9 - 16	90105-10189	20 - 28
5DH-23183-00	24 - 4	17D-25311-00	31 - 1	5UN-25914-00	32 - 17	2CR-81801-00	38 - 3	BR9-8591A-10	40 - 7	90105-10361	20 - 20
1C3-23188-L0	26 - 15	17D-25317-00	31 - 2	5DH-25914-50	32 - 15	8FA-8181L-00	38 - 9	4FP-H182L-00	38 - 4	90105-10367	1 - 16

NUMERICAL INDEX

PART NO.	REF. NO.	PART NO.	REF. NO.	PART NO.	REF. NO.	PART NO.	REF. NO.	PART NO.	REF. NO.	PART NO.	REF. NO.
90109-06034	39 - 3	90170-14171	2 - 12	90240-08120	35 - 6	90430-06156	7 - 3	91808-16023	1 - 7	93332-00081	25 - 1
90109-060E9	14 - 2	90170-20211	16 - 3	90240-10004	35 - 13	90430-06166	13 - 4	91810-18008	15 - 5	93340-21209	16 - 16
90109-06232	26 - 51	90170-20327	16 - 14	90267-32013	9 - 11	90430-08119	1 - 9	91A20-05065	6 - 11	93342-22217	23 - 3
90109-081G1	31 - 7	90179-08019	31 - 22	90267-32146	20 - 19	90430-10004	40 - 3	92012-06010	20 - 36	93440-07182	5 - 7
90110-05003	37 - 8	90179-10658	20 - 21	90267-48021	12 - 17	90430-10005	34 - 2		20 - 38	93440-10085	16 - 17
90110-05033	7 - 2		20 - 26	90269-06081	20 - 41		36 - 14	92902-10200	24 - 20	93440-25084	17 - 5
90110-05058	27 - 18	90179-12657	37 - 3	90280-03006	2 - 25	90430-10188	13 - 10	93101-14164	14 - 17		17 - 18
90110-05062	40 - 5	90179-18011	29 - 14	90282-05034	2 - 17	90445-09008	27 - 6	93102-08004	5 - 3	93440-28062	17 - 22
90110-05064	12 - 16	90179-20001	17 - 33	90340-12007	1 - 5	90450-22001	6 - 19	93102-08307	5 - 4	93440-41178	4 - 3
90110-05066	9 - 5	90179-24004	25 - 10	90340-14021	14 - 6	90450-25001	6 - 18	93102-10008	13 - 34	93450-19052	2 - 24
90110-06182	13 - 8	90179-28015	25 - 7	90340-36007	14 - 4	90450-28001	6 - 17	93102-30014	29 - 4	93511-32027	16 - 18
	13 - 27	90185-08008	31 - 8	90387-05048	40 - 9	90450-32003	6 - 20	93102-32014	17 - 28	93603-12030	5 - 2
90110-06345	15 - 6	90185-08009	20 - 16	90387-05055	9 - 20	90450-58006	9 - 6	93102-32337	31 - 4	93604-10011	5 - 10
90110-06349	38 - 14	90185-10012	24 - 22	90387-06065	6 - 22	90450-60004	9 - 3	93106-22002	23 - 4	93608-33002	19 - 13
90110-06363	13 - 13	90185-14010	23 - 31	90387-06105	25 - 4	90464-13073	41 - 17	93109-14010	19 - 16	93612-16254	1 - 15
90110-06391	13 - 12	90185-16002	23 - 16	90387-06106	20 - 33	90464-13077	41 - 16	93109-21001	23 - 26	9383E-13233	17 - 31
90110-06392	13 - 14	90185-22011	31 - 24	90387-06170	27 - 9	90464-17003	41 - 15	93109-25001	23 - 20	94416-21059	29 - 5
90110-06401	37 - 6	90201-03008	9 - 12	90387-06259	21 - 2	90464-31002	20 - 39	93109-28043	23 - 5	94421-19018	31 - 11
90111-06116	36 - 11	90201-05017	12 - 3	90387-06273	9 - 25	90465-08062	14 - 15	93210-11073	35 - 3	94591-57122	4 - 4
90111-06171	27 - 23	90201-08043	20 - 17	90387-06284	27 - 24	90465-10098	38 - 1	93210-12010	7 - 5	94682-28001	31 - 27
90116-06037	1 - 12		31 - 9	90387-066J9	41 - 5		41 - 35	93210-14369	14 - 7	94701-00415	1 - 13
90116-06048	1 - 22	90201-08044	35 - 7	90387-066Y6	27 - 12	90467-090A2	6 - 12	93210-16500	6 - 3	94701-00431	1 - 13
90119-06133	41 - 21	90201-08045	20 - 9	90387-07045	9 - 31	90467-20030	11 - 2	93210-19123	14 - 9	94A40-04114	31 - 26
90119-06170	22 - 6	90201-10025	1 - 18		22 - 20	90468-16001	35 - 4	93210-19758	5 - 15	95022-06008	41 - 30
	22 - 15	90201-10032	35 - 14		22 - 28	90480-01028	9 - 24	93210-21001	40 - 6	95022-06010	1 - 10
90119-06212	22 - 5	90201-10035	25 - 14	90387-08041	20 - 10	90480-08608	31 - 17	93210-22164	17 - 30		5 - 12
90119-06217	22 - 33	90201-10045	15 - 2	90387-08057	22 - 2	90480-10068	22 - 21	93210-24253	6 - 5		13 - 30
90119-06262	6 - 23		20 - 22		22 - 8		22 - 29	93210-357A3	14 - 5		41 - 14
90119-06268	21 - 3		20 - 27	90387-08081	12 - 14	90480-10289	27 - 13	93210-45708	8 - 3	95022-06012	6 - 2
	21 - 9	90201-127E1	37 - 4	90387-08086	21 - 7	90480-11015	40 - 13	93300-60801	5 - 5		14 - 13
90119-06271	27 - 14	90201-14020	23 - 30	90387-08110	12 - 27	90480-12237	9 - 26	93300-60839	20 - 13	95022-06016	8 - 4
90119-06M12	19 - 15	90201-15701	14 - 18	90387-086N4	20 - 14	90480-13025	41 - 4	93306-00426	17 - 12		40 - 14
90119-08170	12 - 30	90201-16018	23 - 17	90387-14016	23 - 27	90480-13029	40 - 10	93306-00447	17 - 11	95022-06020	6 - 6
90119-08174	12 - 13	90201-203E7	17 - 16	90387-14020	19 - 11	90480-15012	6 - 21	93306-20335	2 - 10		39 - 10
90119-08177	12 - 31	90201-21014	23 - 23	90387-16026	23 - 21	90480-20005	12 - 26	93306-20532	17 - 1	95022-06025	5 - 11
90149-05040	37 - 5	90201-22023	31 - 25	90387-17018	13 - 11	90501-052G5	19 - 6	93306-205A5	17 - 27		14 - 25
90149-06083	2 - 15	90201-253K0	17 - 4	90387-17019	23 - 6	90501-06022	18 - 3	93306-30633	2 - 7	95022-06030	14 - 12
90149-10031	20 - 4		17 - 21	90387-1714S	23 - 7	90501-064L1	18 - 11	93306-80502	18 - 5		14 - 22
90151-06005	27 - 22	90201-286K9	25 - 8	90387-20028	17 - 15	90501-240A5	16 - 9	93306-90409	18 - 4	95022-06035	1 - 19
90151-06024	4 - 8	90208-20007	16 - 2	90387-21005	17 - 8	90506-18019	35 - 5	93306-90510	31 - 3		1 - 31
90151-06051	30 - 2	90209-16011	23 - 22	90387-25037	17 - 29	90508-28015	35 - 11	93306-97203	29 - 2	95022-06070	14 - 26
	32 - 2	90209-21332	17 - 10	90387-28012	17 - 26	90508-28018	35 - 12	93310-63458	2 - 5	95022-08012	1 - 8
90151-06053	13 - 24	90209-22008	17 - 19	90401-10172	34 - 3	90508-29023	19 - 12	93315-32166	23 - 19	95022-08040	20 - 11
90151-08007	13 - 22	90209-26348	17 - 24		36 - 13	90508-29041	18 - 13		23 - 25	95022-10016	13 - 9
90159-06010	16 - 10	90215-10009	2 - 19	90430-06014	1 - 11	91312-06020	9 - 2	93317-106B4	13 - 32	95024-08040	12 - 10
90159-06021	7 - 6	90215-14287	2 - 13		4 - 14	91402-20012	35 - 8	93317-11096	13 - 33		12 - 29
90159-06027	18 - 14	90215-20005	16 - 13		5 - 13	91402-25015	35 - 15	93317-22262	23 - 2	95027-06016	9 - 35
90170-10013	2 - 18	90215-21003	17 - 32		14 - 14	91808-16023	1 - 6	93332-00068	25 - 5	95302-05600	39 - 6

NUMERICAL INDEX

PART NO.	REF. NO.	PART NO.	REF. NO.	PART NO.	REF. NO.	PART NO.	REF. NO.	PART NO.	REF. NO.
95302-06700	38 - 11								
	38 - 13								
95602-10200	24 - 19								
	25 - 15								
95701-06500	34 - 14								
95702-06500	1 - 33								
	23 - 13								
95704-06500	12 - 6								
97702-50520	9 - 17								
97702-60016	21 - 11								
98502-05010	36 - 16								
	36 - 18								
98502-05014	9 - 13								
	9 - 22								
98507-05020	33 - 8								
98706-04012	34 - 8								
98980-06008	12 - 4								
99009-18500	13 - 35								
99009-22500	14 - 19								
99009-42700	31 - 5								
99530-08016	14 - 11								
99530-12016	14 - 21								
99530-14016	1 - 30								
	13 - 6								